

# M160-250xS Non-Fused

## M160ExS/M200ExS/M250ExS

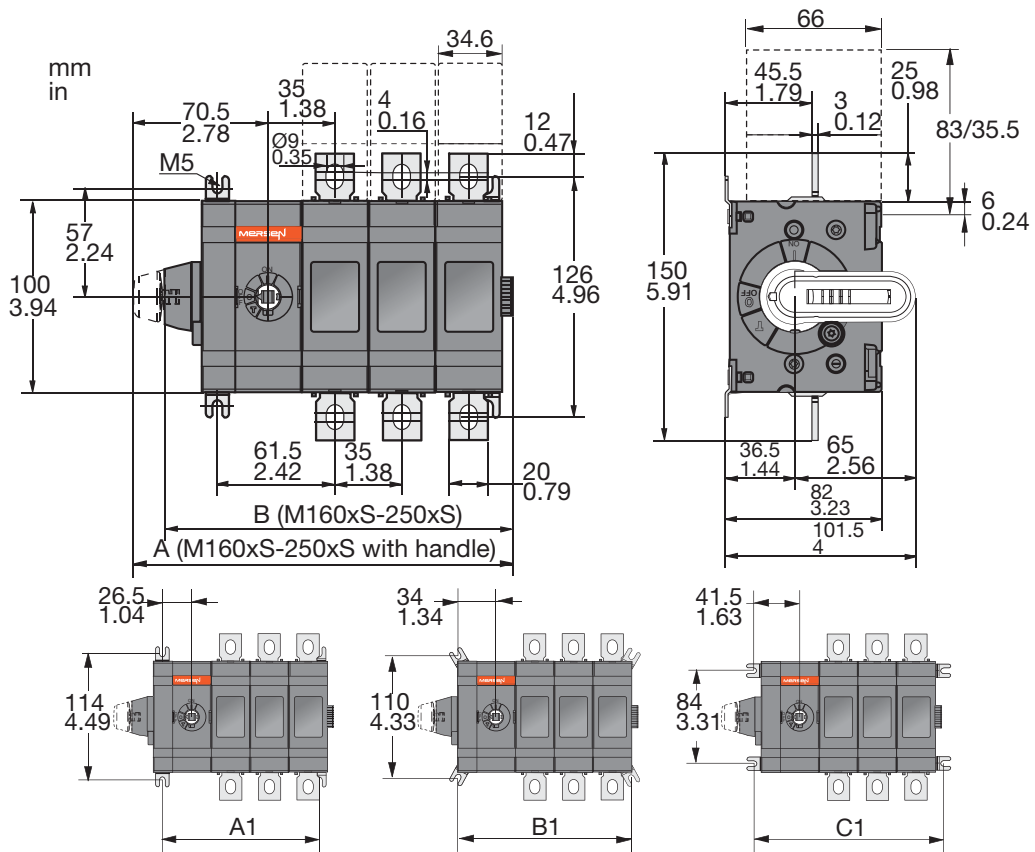
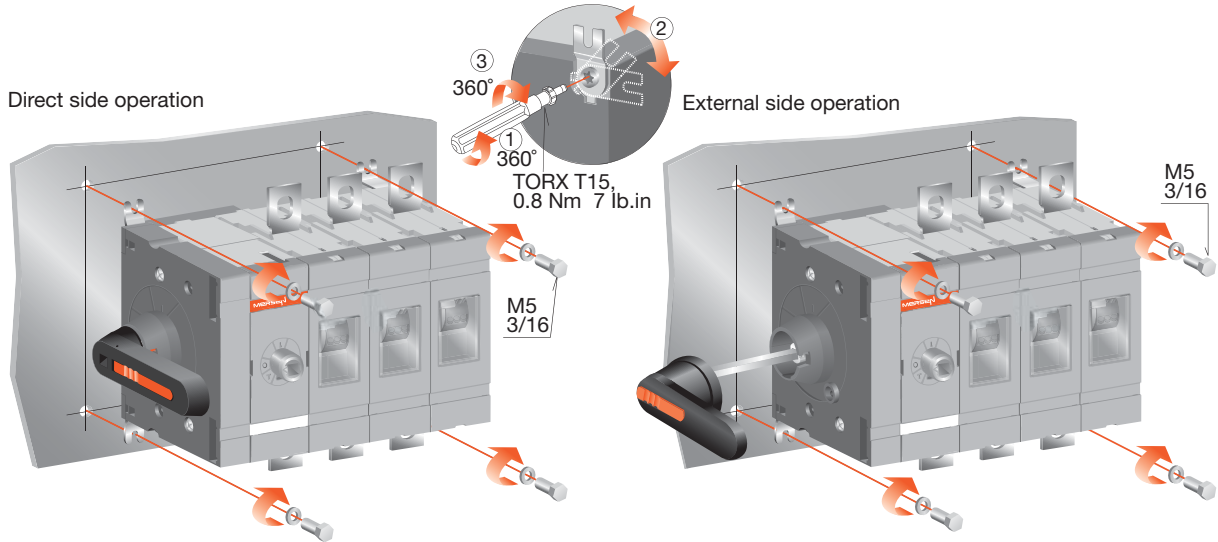

M160/200/250ExS, 03 or 30 configurations				
	01	02	03	04
	mm / in	mm / in	mm / in	mm / in
A	128.5 / 5.06	163.5 / 6.44	198.5 / 7.82	233.5 / 9.2
B	111.5 / 4.39	146.5 / 5.77	181.5 / 7.15	216.5 / 8.53
A1	71.5 / 2.81	106.5 / 4.2	141.5 / 5.57	176.5 / 6.95
B1	86.5 / 3.41	121.5 / 4.79	156.5 / 6.16	191.5 / 7.54
C1	101.5 / 4	136.5 / 5.38	171.5 / 6.75	206.5 / 8.14

# M160-250xS Non-Fused

## M200UxS

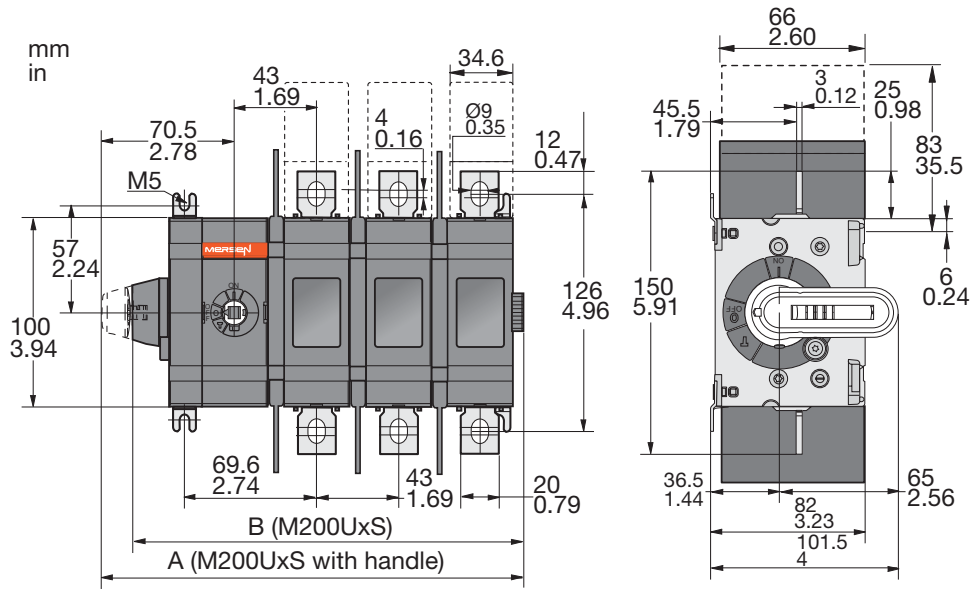

	M200UxS, 03 or 30 configuration			
	US01	US02	US03	US04
	mm / in	mm / in	mm / in	mm / in
A	136.5 / 5.38	179.5 / 7.07	222.5 / 8.77	265.5 / 10.5
B	119.5 / 4.71	162.6 / 6.4	205.5 / 8.1	248.5 / 9.79
A1	79.5 / 3.13	122.5 / 4.83	165.5 / 6.52	208.5 / 8.21
B1	94.5 / 3.72	137.5 / 5.42	180.5 / 7.11	223.5 / 8.81
C1	109.5 / 4.31	152.5 / 6.01	195.5 / 7.7	238.5 / 9.4

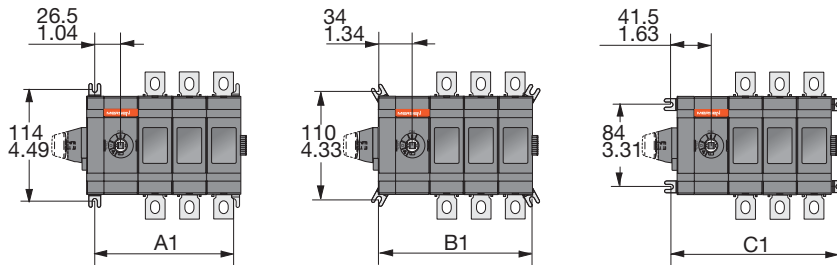

## Clearances per UL98

Height mm/in	406/16
Width mm/in	255/10
Depth mm/in	152/6

Minimum enclosure size or equivalent volume

A	0
B	13 mm/0.5 in
D	13 mm/0.5 in

Cable size	
AWG	C
4-3	100 mm/4 in
2	100 mm/4 in
1	100 mm/4 in
1/0	125 mm/5 in
2/0	150 mm/6 in
3/0 - 4/0	175 mm/7 in

Cable size	
MCM	C
250	200 mm/8 in
300	250 mm/10 in

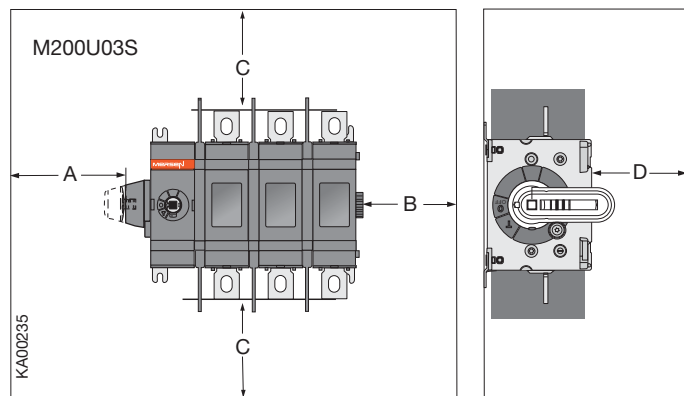

# M160-250xS Non-Fused

## 4Px250 Neutral pole

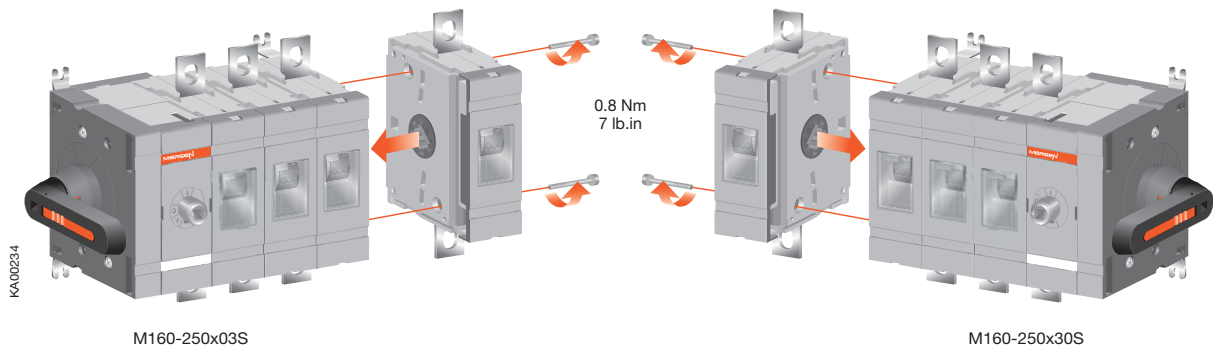

## Handle shaft

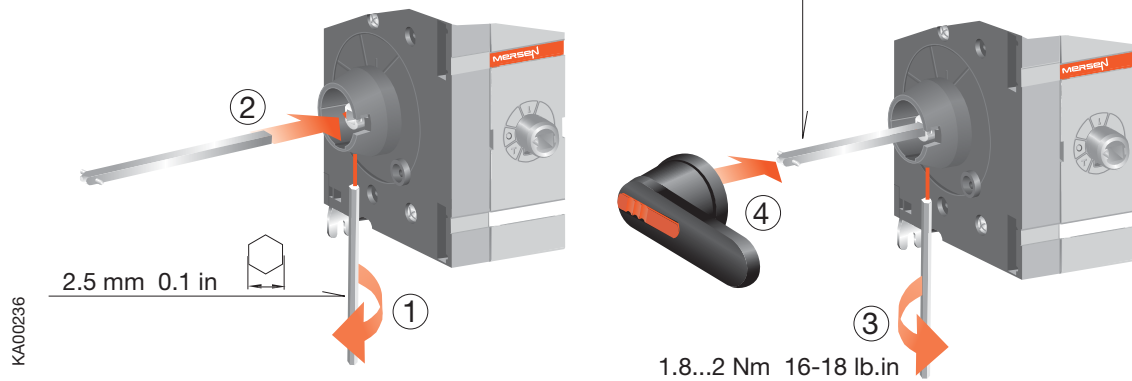
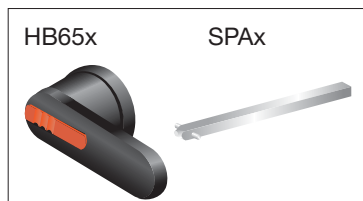

## Handles

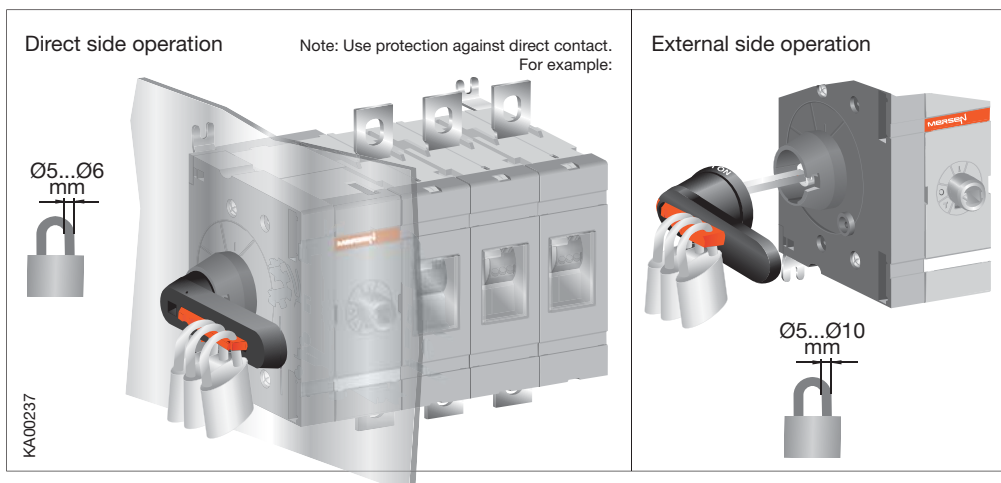

# M160-250xS Non-Fused

## Label

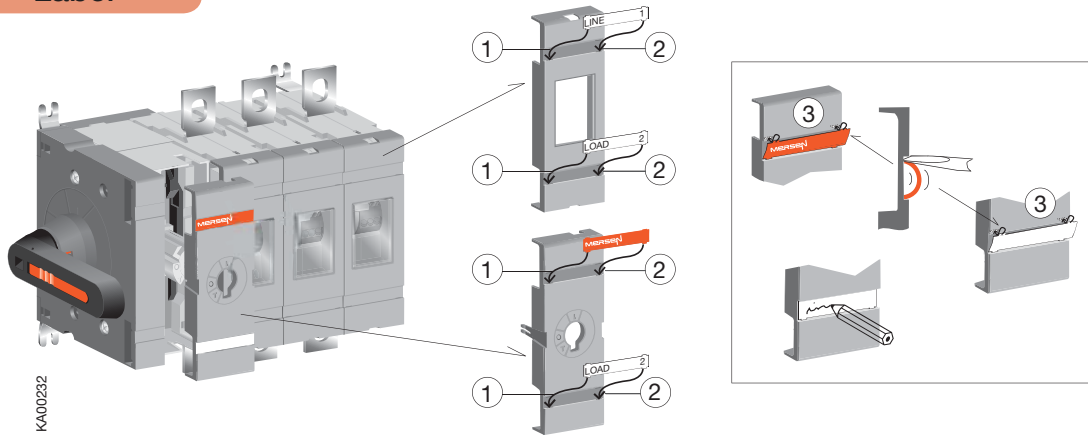

## Lugs

M200U

LUG200 - AWG #6 - 300 MCM  
LUG206 - 6 x AWG #4 - #6

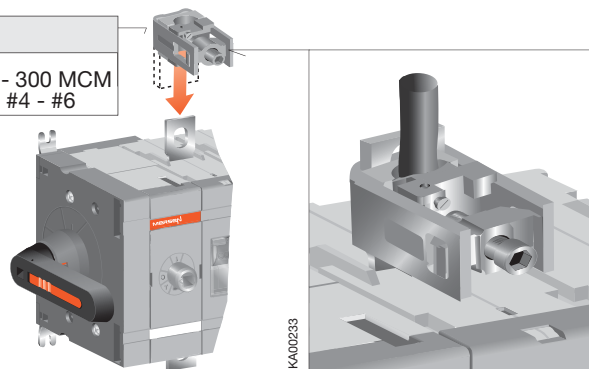

## Internally-mounted Auxiliary contacts

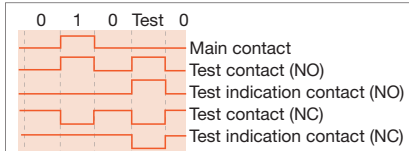
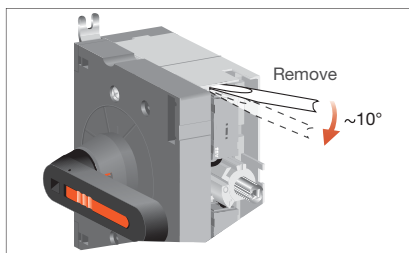
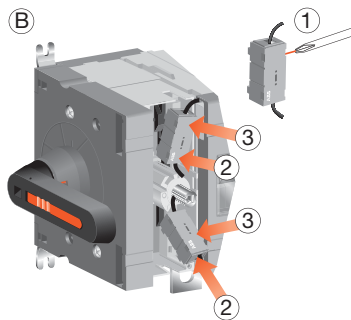
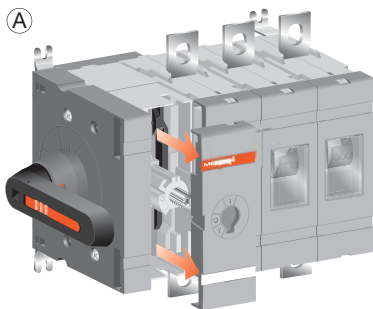

KA00238

NO: OA1G10  
NC: OA3G01

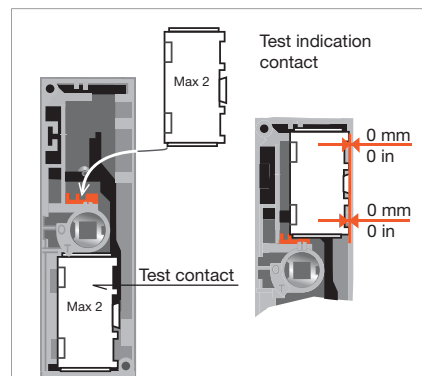

OR

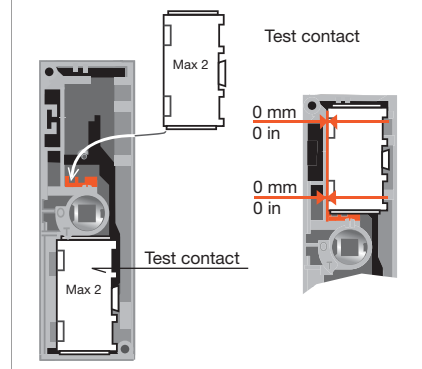

# M160-250xS Non-Fused

## Terminal Shrouds

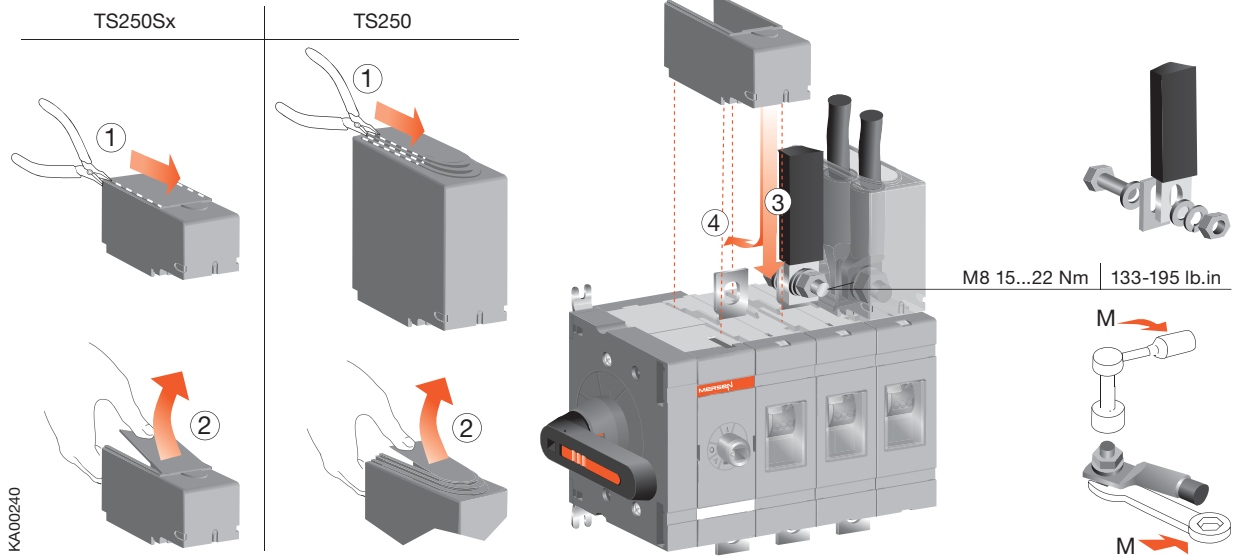

## Externally-mounted Auxiliary contacts

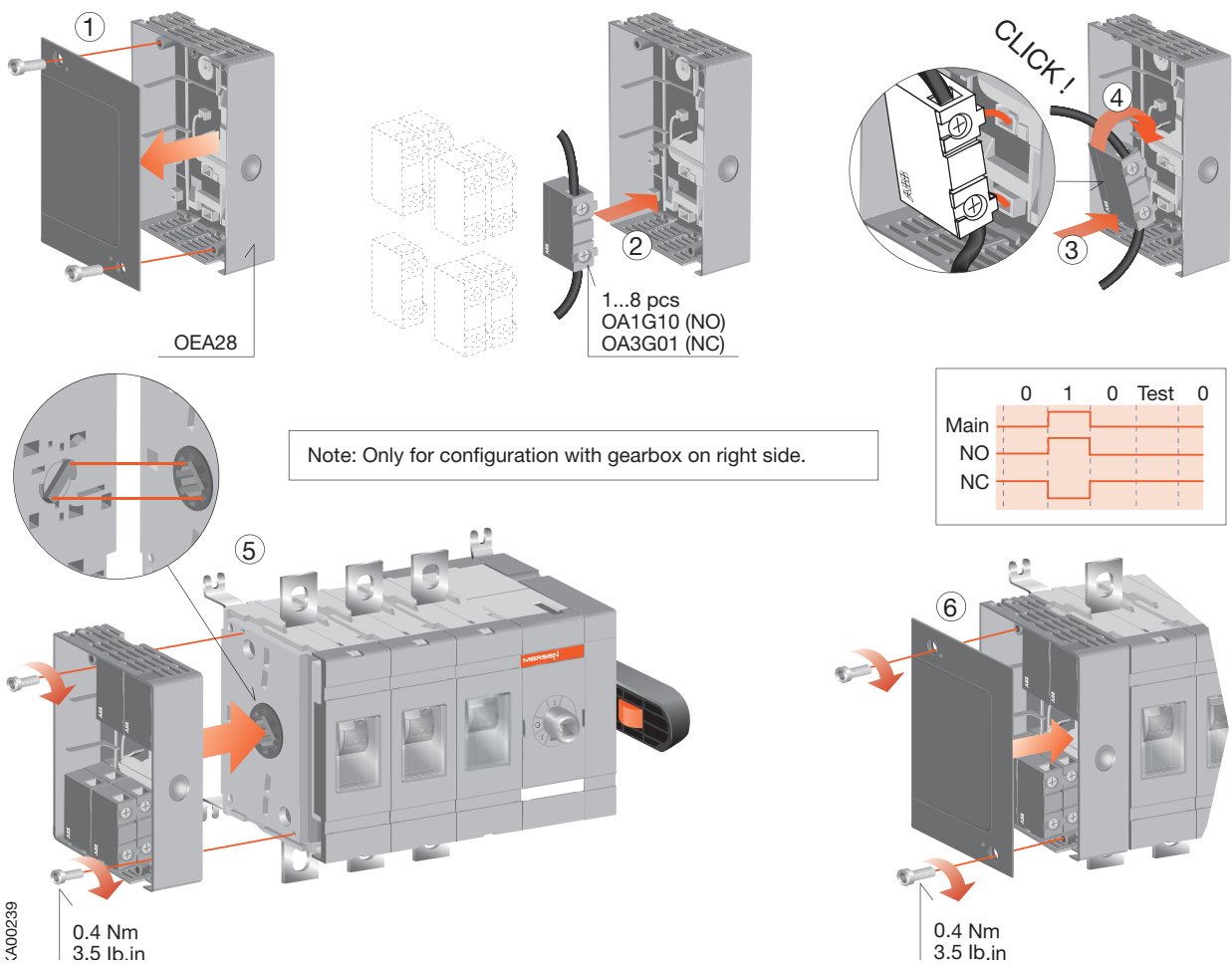



[ep.mersen.com](http://ep.mersen.com)