



NH FUSE SWITCH
DISCONNECTORS
& NH FUSE SYSTEM

MULTIVERT®
MULTIBLOC®
MULTIFIX®



CONTENTS



MULTIBLOC®

3 - 23

MULTIBLOC® 000.ST8	4
MULTIBLOC® 000.RST8	4
MULTIBLOC® 00.ST8	5
MULTIBLOC® 00.ST9	8
MULTIBLOC® 00.RST9	10
MULTIBLOC® 1.ST8	13
MULTIBLOC® 1.RST8	16
MULTIBLOC® 2.ST8	18
MULTIBLOC® 2.RST8	19
MULTIBLOC® 3.ST8	21
MULTIBLOC® 4a.ST8	23



MULTIVERT®

24 - 63

MULTIVERT® 160A/60mm	25
MULTIVERT® 160A	27
MULTIVERT® 160A/185mm	33
MULTIVERT® 250A	38
MULTIVERT® 400A	44
MULTIVERT® 630A	51
MULTIVERT® 630A 4P (3P+N)	58
MULTIVERT® 800A, 1260A	59
MULTIVERT® 1260A, 1600A	60
MULTIVERT® 1000A	62
MULTIVERT® 630kVA/910A	62
MULTIVERT® 1250A	63
MULTIVERT® 1600A	63



MULTIFIX®

64 - 79

MULTIFIX® 60 Universal Bus Bar Carriers	65
MULTIFIX® 60 Bus Bar Carriers	66
MULTIFIX® 60 D02 Vertical Fuse Bases E18	66
MULTIFIX® 60 D-Vertical Fuse Bases	67
MULTIFIX® 60 Touch Protection Cover Caps	68
MULTIFIX® 60 Terminal Clamp Module	70
MULTIFIX® 60 Component Adapters	70
MULTIFIX® 60 D02 Vertical Switch Fuse Disconnecter	71
MULTIFIX® 60 MULTIBLOC® NH Fuse Switch Disconnecter	72
MULTIFIX® 60 MULTIVERT® Vertical NH Fuse Switch Disconnecter	75
MULTIFIX® 60 Plate Clamps	77
MULTIFIX® 60 Covering and Compartmentalizing Material	77
MULTIFIX® 60 System cover	78

NH FUSE SWITCH DISCONNECTOR

MULTIBLOC®

In accordance with IEC/EN 60 947-3.

For NH-fuse links in accordance with IEC/EN 60 269-2, VDE 0636-2.

- From size 000 (100A) up to size 4a (1600A) ratings
- Design for 60mm busbar installation (snap on) or for design bottom fitting
- 1-pôle to 4-pôle available for bottom fitting variants according to sizes
- Touch protection IP 20 in closed position (up to IP 30 for Multibloc 00.ST9 & 00.RST9) – IP 10 in open position)
- Suitable for top/bottom cable terminal connections
- Windows with voltage testing holes
- Various Cable termination: screw, clamp straps, AlCu clamp, frame clamps, Clamping blocks
- Parking position of switch operating cover even with fuse links inserted for Multibloc Sizes 00 to 3
- Padlocking and sealing available as standard or option, according to sizes
- Electronic or electro-mechanic fuse monitoring optional for Multibloc sizes 00 to size 3
- Various accessories: indicator for switch door position, DIN rail adapter, modular system of cover shrouds...



MULTIBLOC	NUMBER OF POLES	MOUNTING PLATE	BUSBAR SYSTEM SIZE			DIN RAILS
			40 MM	60 MM	100 MM	
Size 000	3	•		•		•
Size 00	1	•		•		•
	2	•				
	3	•		•		
	4	•				
Size 1	1	•		•		
	2	•				
	3	•	•	•	•	•
	4	•				
Size 2	3	•	•	•	•	
	4	•				
Size 3	3	•		•	•	
	4	•				
Size 4a	1	•				
	3	•				

NH FUSE SWITCH DISCONNECTOR

MULTIBLOC® 000.ST8

PRODUCT RANGE

Size 000, 100A, 690VAC, Design for Bottom Fitting, Triple Pole

MULTIBLOC® 000.ST8 size 000 100 A, 690VAC bottom fitting, triple pole



COOST601

CAT. NUMBER	ITEM NUMBER	POLES	CABLE TERMINATION COMPONENTS	PKG	WEIGHT
COOST601	J1002118	3	6 frame clamps 1,5–50 mm ²	1 piece	0.46 kg

ACCESSORIES



COOSZAB

Cover shields

CAT. NUMBER	ITEM NUMBER	DESIGN	PKG	WEIGHT
COOSZAB	Q1002170	cover shield 180 x 110 for 1switch	1 piece	27 g



COOSZDIN

Installation devices

CAT. NUMBER	ITEM NUMBER	DESIGN	PKG	WEIGHT
COOSZDIN	Z1022970	adapter for installation on to DIN-rails in accordance with EN 50 022, 35 x 7,5 mm and 35 x 15 mm for 000.ST8 triple pole	1 piece	10 g



COOSZHID

Indication facilities

CAT. NUMBER	ITEM NUMBER	DESIGN	PKG	WEIGHT
COOSZHID	R1022986	indicator for switch door position micro switch, 1 change-over contact 5 A, 250 V for MULTIBLOC® 000.ST8 1 set = 3 pieces	1 piece	60 g



COOSZLFA

Insulated bus bars

CAT. NUMBER	ITEM NUMBER	DESIGN	PKG	WEIGHT
COOSZLFA	Q1022985	spare way cover for three poles of insulated bus bar	5 pieces	10 g

MULTIBLOC® 000.RST8

Size 000, 100A, 690VAC, Design for bus bar installation, Triple Pole

MULTIBLOC® 000.RST8 size 000 100 A, 690VAC bus bar installation, triple pole



1.002.571

CAT. NUMBER	ITEM NUMBER	POLES	CABLE TERMINATION COMPONENTS	PKG	WEIGHT
1.002.571	L1002166	3	3 frame clamps 2,5-50 mm ² bottom terminal	1 piece	0.6 kg
1.002.572	L1023050	3	3 frame clamps 2,5-50 mm ² top terminal	1 piece	0.62 kg

NH FUSE SWITCH DISCONNECTOR

MULTIBLOC® 000.RST8

ACCESSORIES

Size 000, 100A, 690VAC, Design for bus bar installation, Triple Pole

Cover/shrouds for cable termination



1.002.644

CAT. NUMBER	ITEM NUMBER	DESIGN	PKG	WEIGHT
1.002.644	N1022983	cover for cable terminal connection, 1 set = 2 pieces	1 set	68 g



1.002.643

Indication facilities

CAT. NUMBER	ITEM NUMBER	DESIGN	PKG	WEIGHT
1.002.643	T1022988	indicator for switch door position micro switch 1 change-over contact 5 A, 250 V for MULTIBLOC® 000.RST8 1 set = 3 pieces	1 piece	0.1 kg

MULTIBLOC® 00.ST8

PRODUCT RANGE

Size 00 160A, 690VAC Bottom Fitting, 1-,2-,4-pole

MULTIBLOC® 00.ST8 size 00 160A, 690VAC bottom fitting, single pole



1.000.053

CAT. NUMBER	ITEM NUMBER	POLES	CABLE TERMINATION COMPONENTS	DESIGN	PKG	WEIGHT
1.000.053	F229292	1	2 M8 terminal screws	-	1 piece	0.32 kg
1.000.054	E1022998	1	2 clamp straps Cu 4-70 mm ²	-	1 piece	0.32 kg
1.000.114	F1022999	1	2 Al/Cu clamps 1,5-70 mm ² round stranded, 95 mm ² sectoral solid	-	1 piece	0.35 kg
1.001.817	G1023000	1	2 M8 terminal screws	for direct installation on to bus bars with M8 screw	1 piece	0.29 kg



1.001.817

MULTIBLOC® 00.ST8 size 00 160A, 690VAC bottom fitting, double pole



1.000.139

CAT. NUMBER	ITEM NUMBER	POLES	CABLE TERMINATION COMPONENTS	DESIGN	PKG	WEIGHT
1.000.139	G229293	2	4 M8 terminal screws	2 poles	1 piece	0.62 kg
1.004.453	E1062213	2	4 M8 terminal screws	with ready fitted special solid link as neutral conductor in pole 2 for leading and lagging switching (right side)	1 piece	1.42 kg
1.000.140	H1023001	2	4 clamp straps Cu 4-70 mm ²	2 poles	1 piece	0.62 kg

NH FUSE SWITCH DISCONNECTOR

MULTIBLOC® 00.ST8

PRODUCT RANGE

Size 00 160A, 690VAC Bottom Fitting, 1-,2-,4-pole

MULTIBLOC® 00.ST8 size 00 160A, 690VAC bottom fitting, quadruple pole



1.000.141



1.002.377

CAT. NUMBER	ITEM NUMBER	POLES	CABLE TERMINATION COMPONENTS	DESIGN	PKG	WEIGHT
1.000.141	J1023002	4	8 M8 terminal screws	pole 4 right side	1 piece	1.04 kg
1.000.142	K1023003	4	8 clamp straps Cu 4–70 mm²	pole 4 right side	1 piece	1.04 kg
1.001.575	L1023004	4	8 M8 terminal screws	pole 4 left side	1 piece	1.04 kg
1.002.377	T1002127	4	8 M8 terminal screws	with ready fitted special solid link as neutral conductor in pole 4 for leading and lagging switching	1 piece	1.8 kg
1.003.141	N1023006	4	8 clamp straps Cu 4-70 mm²	with ready fitted special solid link as neutral conductor in pole 4 for leading and lagging switching	1 piece	1.8 kg

ACCESSORIES



1.002.764

Cover shields

CAT. NUMBER	ITEM NUMBER	DESIGN	PKG	WEIGHT
1.002.764	T1022965	cover shield for installation in distribution units size (width x height): 220 x 240 mm for one 00.ST8 quadruple pole	1 piece	93 g



1.000.149

Cover/shrouds for cable termination

CAT. NUMBER	ITEM NUMBER	DESIGN	PKG	WEIGHT
1.000.149	V229282	cover for cable terminal connection for 00.ST8 single pole, 1 set = 2 pieces	1 set	21 g
1.000.148	W229283	cover for cable terminal connection for 00.ST9 triple pole, 1 set = 2 pieces	1 set	43 g



1.000.151



1.000.152

Installation devices

CAT. NUMBER	ITEM NUMBER	DESIGN	PKG	WEIGHT
1.000.151	B229288	adapter for installation between DIN-rails in accordance with EN 60715, DIN-rail distance 125mm for 00.ST8 single pole	1 piece	80 g
1.000.152	C229289	adapter for installation between DIN-rails in accordance with EN 60715, DIN-rail distance 150mm for 00.ST8 single pole	1 piece	0.14 kg

NH FUSE SWITCH DISCONNECTOR

MULTIBLOC® 00.ST8

Size 00 160A, 690VAC Bottom Fitting, 1-,2-,4-pole

ACCESSORIES



MZ00HD

Indication facilities

CAT. NUMBER	ITEM NUMBER	DESIGN	PKG	WEIGHT
MZ00HD	V1022989	indicator for switch door position micro switch 1 "a" contact/ 1 "b" contact, 5 A, 250 V for MULTIBLOC® 00.ST8 1-, 2-, 4-pole	1 piece	90 g



1.000.155

Locking and sealing devices/cover sealing device

CAT. NUMBER	ITEM NUMBER	DESIGN	PKG	WEIGHT
1.000.155	L229297	cover sealing device-installation set for 00.ST8 1-, 2-, 4-pole and 1.ST8/RST8	1 piece	10 g



1.000.150

Locking and sealing devices/locking device for window

CAT. NUMBER	ITEM NUMBER	DESIGN	PKG	WEIGHT
1.000.150	K229296	locking device for window for 00.ST8 1-, 2-, 4-pole and 1./2.ST8/RST8 1 set = 3 pieces	1 set	20 g



00SZS



00SZESK



1.003.433



00SZSV6

Varieties of cable termination

CAT. NUMBER	ITEM NUMBER	DESIGN	PKG	WEIGHT
00SZS	M229298	M8 terminal screw for switch gear size 00 1 set = 3 pieces	1 set	35 g
00SZESK	E214594	clamp strap Cu 4-70 mm ² for switch gear size 00 1 set = 3 pieces	1 set	35 g
00SZA70	R211523	Al/Cu clamp 1,5-70 mm ² for switch gear size 00 1 set = 3 pieces	1 set	75 g
1.003.571	V1033684	Al/Cu clamp 50-95 mm ² round stranded for switch gear size 00 1 set = 3 pieces	1 set	88 g
1.003.433	L1022958	triple clamp per pole 1.5 up to 16 mm ² 1 set = 3 pieces	1 set	0.14 kg
00SZSV6	K1022957	V-shaped lug size 00, M8, for V-terminal clamp size 00 for switch gear size 00 with screw terminal supplementary set for V-terminal with V-terminal clamps 1 set = 3 pieces	1 set	0.13 kg

Neutral conductor



00SZNS

CAT. NUMBER	ITEM NUMBER	DESIGN	PKG	WEIGHT
00SZNS	A1023086	neutral conductor support for lateral installation either left or right side of MULTIBLOC® size 00 cable termination clamp strap Cu 4-70 mm ² round stranded/round solid	1 piece	83 g

NH FUSE SWITCH DISCONNECTOR

MULTIBLOC® 00.ST9

PRODUCT RANGE

Size 00, 160A, 690VAC, Design for Bottom Fitting, Triple Pole

MULTIBLOC® 00.ST9 size 00 160A, 690VAC bottom fitting, triple pole



2.030.000



2.030.100



2.030.200

CAT. NUMBER	ITEM NUMBER	POLES	CABLE TERMINATION COMPONENTS	DESIGN	PKG	WEIGHT
2.030.000	P1023007	3	6 M8 terminal screws	-	1 piece	0.75 kg
2.030.100	V1023012	3	6 M8 terminal screws	with electronic fuse monitoring ESU installed (rated voltage = 525VAC)	1 piece	0.86 kg
2.030.200	C1023042	3	6 M8 terminal screws	with electro-mechanic fuse monitoring MZS installed (galvanic isolation)	1 piece	1.39 kg
2.030.300	D1023043	3	6 M8 terminal screws	fixed window to protect against unauthorized connection	1 piece	0.75 kg
2.031.000	E1023044	3	6 clamp straps Cu 4-70mm ²	-	1 piece	0.75 kg
2.031.300	F1023045	3	6 clamp straps Cu 4-70mm ²	fixed window to protect against unauthorized connection	1 piece	0.75 kg
2.032.000	G1023046	3	6 Al/Cu clamps 1,5-70 mm ² round stranded, 95 mm ² sectoral solid	-	1 piece	0.85 kg
2.033.000	H1023047	3	6 frame clamps Cu 2,5-70 mm ² factory assembled	-	1 piece	0.7 kg
2.034.000	J1023048	3	3 M8 terminal screws, 3 clamp straps Cu 4-70mm ²	-	1 piece	0.75 kg
2.035.000	K1023049	3	3 M8 terminal screws 3 Al/Cu clamps 1,5-70 mm ² round stranded, 95 mm ² sectoral solid	-	1 piece	0.75 kg

NH FUSE SWITCH DISCONNECTOR

MULTIBLOC® 00.ST9

Size 00, 160A, 690VAC, Design for Bottom Fitting, Triple Pole

ACCESSORIES

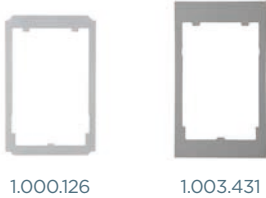

1.000.126

1.003.431



1.002.874



1.000.127



1.000.128



1.000.148



1.000.153



1.000.154



1.000.852

Cover shields

CAT. NUMBER	ITEM NUMBER	DESIGN	PKG	WEIGHT
1.000.126	Y229285	cover shield for installation in distribution units size (width x height): 123 x 190 mm for one 00.ST9/00.RST9	1 piece	22 g
1.003.431	N1022960	cover shield for installation in distribution units size (width x height): 123 x 210 mm for one 00.ST9/00.RST9	1 piece	30 g
1.002.874	S1022964	cover shield for installation in distribution units size (width x height): 231 x 210 mm for two 00.ST9/00.RST9	1 piece	57 g
1.000.127	Z229286	cover shield for installation in distribution units size (width x height): 231 x 190 mm for two 00.ST9/00.RST9	1 piece	46 g
1.000.128	A229287	cover shield for installation in distribution units size (width x height): 339 x 190 mm for three 00.ST9/00.RST9	1 piece	30 g
1.002.870	R1022963	cover shield for installation in distribution units size (width x height) 231 x 210 mm for one 00.ST9/00.RST9 + lateral spare way cover right side	1 piece	95 g

Cover/shrouds for cable termination

CAT. NUMBER	ITEM NUMBER	DESIGN	PKG	WEIGHT
1.000.148	W229283	cover for cable terminal connection for 00.ST9 triple pole, 1 set = 2 pieces	1 set	43 g

Installation devices

CAT. NUMBER	ITEM NUMBER	DESIGN	PKG	WEIGHT
1.000.153	C229887	adapter for installation between DIN-rails in accordance with EN 60715, DIN-rail distance 125mm for 00.ST9 triple pole	1 piece	0.24 kg
1.000.154	D229888	adapter for installation between DIN-rails in accordance with EN 60715, DIN-rail distance 150mm for 00.ST9 triple pole	1 piece	0.29 kg

Indication facilities

CAT. NUMBER	ITEM NUMBER	DESIGN	PKG	WEIGHT
1.000.852	Q1002285	indicator for switch door position micro switch, 1 change-over contact 5 A, 250 V	1 piece	90 g

NH FUSE SWITCH DISCONNECTOR

MULTIBLOC® 00.ST9

ACCESSORIES

Size 00, 160A, 690VAC, Design for Bottom Fitting, Triple Pole

Varieties of cable termination



CAT. NUMBER	ITEM NUMBER	DESIGN	PKG	WEIGHT
OOSZS	M229298	M8 terminal screw for switch gear size 00 1 set = 3 pieces	1 set	35 g
OOSZESK	E214594	clamp strap Cu 4-70 mm ² for switch gear size 00 1 set = 3 pieces	1 set	35 g
OOSZA70	R211523	Al/Cu clamp 1,5-70 mm ² for switch gear size 00 1 set = 3 pieces	1 set	75 g
1.003.571	V1033684	Al/Cu clamp 50-95 mm ² round stranded for switch gear size 00 1 set = 3 pieces	1 set	88 g
1.003.433	L1022958	triple clamp per pole 1.5 up to 16 mm ² 1 set = 3 pieces	1 set	0.14 kg
OOSZSV6	K1022957	V-shaped lug size 00, M8, for V-terminal clamp size 00 for switch gear size 00 with screw terminal supplementary set for V-terminal with V-terminal clamps 1 set = 3 pieces	1 set	0.13 kg

Neutral conductor



CAT. NUMBER	ITEM NUMBER	DESIGN	PKG	WEIGHT
OOSZNS	A1023086	neutral conductor support for lateral installation either left or right side of MULTIBLOC® size 00 cable termination clamp strap Cu 4-70 mm ² round stranded/round solid	1 piece	83 g

MULTIBLOC® 00.RST9

PRODUCT RANGE

Size 00, 160A, 690VAC, Design for bus bar installation, Triple Pole

MULTIBLOC® 00.RST9 size 00 160A, bus bar installation 40mm, triple pole



CAT. NUMBER	ITEM NUMBER	POLES	BUS BAR INSTALLATION	CABLE TERMINATION COMPONENTS	PKG	WEIGHT
2.074.000	W1022990	3	40 mm clamping bar	3 M8 terminal screws 3 clamp straps 4-70 mm ²	1 piece	1.06 kg

NH FUSE SWITCH DISCONNECTOR

MULTIBLOC® 00.RST9

PRODUCT RANGE

Size 00, 160A, 690VAC, Design for bus bar installation, Triple Pole

MULTIBLOC® 00.RST9 size 00 160A, bus bar installation 60mm, triple pole



3.084.000



3.084.100



3.084.200

CAT. NUMBER	ITEM NUMBER	POLES	BUS BAR INSTALLATION	CABLE TERMINATION COMPONENTS	DESIGN	PKG	WEIGHT
3.084.000	Z1022993	3	60 mm snap on	3 M8 terminal screws 3 clamp straps 4–70 mm ²	-	1 piece	0.93 kg
3.083.000	X1022991	3	60 mm snap on	3 frame clamps Cu 2,5-70 mm ² factory assembled	-	1 piece	0.88 kg
3.084.300	D1022997	3	60 mm snap on	3 M8 terminal screws 3 clamp straps 4–70 mm ²	fixed window to protect against unauthorized connection	1 piece	0.88 kg
3.083.300	Y1022992	3	60 mm snap on	3 frame clamps Cu 2,5-70 mm ² factory assembled	fixed window to protect against unauthorized connection	1 piece	0.88 kg
3.084.100	B1022995	3	60 mm snap on	3 M8 terminal screws 3 clamp straps 4–70 mm ²	with electronic fuse monitoring ESÜ installed (rated voltage = 525VAC)	1 piece	0.96 kg
3.084.200	C1022996	3	60 mm snap on	3 M8 terminal screws 3 clamp straps 4–70 mm ²	with electro-mechanic fuse monitoring MZS installed (galvanic isolation)	1 piece	1.46 kg

NH FUSE SWITCH DISCONNECTOR

MULTIBLOC® 00.RST9

Size 00, 160A, 690VAC, Design for bus bar installation, Triple Pole

ACCESSORIES

Cover shields



1.000.126

1.003.431



1.002.874



1.000.127



1.000.128



1.000.148



1.000.852



1.000.157

CAT. NUMBER	ITEM NUMBER	DESIGN	PKG	WEIGHT
1.000.126	Y229285	cover shield for installation in distribution units size (width x height): 123 x 190 mm for one 00.ST9/00.RST9	1 piece	22 g
1.003.431	N1022960	cover shield for installation in distribution units size (width x height): 123 x 210 mm for one 00.ST9/00.RST9	1 piece	30 g
1.002.874	S1022964	cover shield for installation in distribution units size (width x height): 231 x 210 mm for two 00.ST9/00.RST9	1 piece	57 g
1.000.127	Z229286	cover shield for installation in distribution units size (width x height): 231 x 190 mm for two 00.ST9/00.RST9	1 piece	46 g
1.000.128	A229287	cover shield for installation in distribution units size (width x height): 339 x 190 mm for three 00.ST9/00.RST9	1 piece	30 g
1.002.870	R1022963	cover shield for installation in distribution units size (width x height) 231 x 210 mm for one 00.ST9/00.RST9 + lateral spare way cover right side	1 piece	95 g

Cover/shrouds for cable termination

CAT. NUMBER	ITEM NUMBER	DESIGN	PKG	WEIGHT
1.000.148	W229283	cover for cable terminal connection for 00.ST9 triple pole, 1 set = 2 pieces	1 set	43 g
1.003.325	F1023114	bus bar touch protection for 00.RST9	1 piece	25 g

Indication facilities

CAT. NUMBER	ITEM NUMBER	DESIGN	PKG	WEIGHT
1.000.852	Q1002285	indicator for switch door position micro switch, 1 change-over contact 5 A, 250 V	1 piece	90 g
1.000.157	S1022987	indicator for switch door position micro switch 1 "a" contact/ 1 "b" contact, 5 A, 250 V for MULTIBLOC® 00.RST9 for 40 mm bus bar system	1 piece	0.1 kg

NH FUSE SWITCH DISCONNECTOR

MULTIBLOC® 00.RST9

ACCESSORIES

Size 00, 160A, 690VAC, Design for bus bar installation, Triple Pole

Varieties of cable termination



00SZS

00SZESK



1.003.433



00SZSV6

CAT. NUMBER	ITEM NUMBER	DESIGN	PKG	WEIGHT
00SZS	M229298	M8 terminal screw for switch gear size 00 1 set = 3 pieces	1 set	35 g
00SZESK	E214594	clamp strap Cu 4-70 mm ² for switch gear size 00 1 set = 3 pieces	1 set	35 g
00SZA70	R211523	Al/Cu clamp 1,5-70 mm ² for switch gear size 00 1 set = 3 pieces	1 set	75 g
1.003.571	V1033684	Al/Cu clamp 50-95 mm ² round stranded for switch gear size 00 1 set = 3 pieces	1 set	88 g
1.003.433	L1022958	triple clamp per pole 1.5 up to 16 mm ² 1 set = 3 pieces	1 set	0.14 kg
00SZSV6	K1022957	V-shaped lug size 00, M8, for V-terminal clamp size 00 for switch gear size 00 with screw terminal supplementary set for V-terminal with V-terminal clamps 1 set = 3 pieces	1 set	0.13 kg

MULTIBLOC® 1.ST8

PRODUCT RANGE

Size 1, 250A, 690VAC, Design for Bottom Fitting, 1-,2-,3-,4-pole

MULTIBLOC® 1.ST8 size 1 250A, 690VAC bottom fitting, single pole



1.000.388



1.001.818

CAT. NUMBER	ITEM NUMBER	POLES	CABLE TERMINATION COMPONENTS	DESIGN	PKG	WEIGHT
1.000.388	Q229876	1	2 M10 terminal screws	-	1 piece	1 kg
1.001.818	S1023056	1	2 M10 terminal screws	for direct installation on to bus bars with M10 screws	1 piece	0.91 kg

MULTIBLOC® 1.ST8 size 1 250A, 690VAC bottom fitting, double pole



1.000.397

CAT. NUMBER	ITEM NUMBER	POLES	CABLE TERMINATION COMPONENTS	PKG	WEIGHT
1.000.397	R229877	2	4 M10 terminal screws	1 piece	2.06 kg

NH FUSE SWITCH DISCONNECTOR

MULTIBLOC® 1.ST8

PRODUCT RANGE

Size 1, 250A, 690VAC, Design for Bottom Fitting, 1-,2-,3-,4-pole



1.000.299



1.002.711

MULTIBLOC® 1.ST8 size 1 250A, 690VAC bottom fitting, triple pole

CAT. NUMBER	ITEM NUMBER	POLES	CABLE TERMINATION COMPONENTS	DESIGN	PKG	WEIGHT
1.000.299	S229878	3	6 M10 terminal screws	-	1 piece	2.42 kg
1.001.239	V1023058	3	3 clamp straps 70–150 mm ² 3 M10 terminal screws	-	1 piece	2.42 kg
1.002.562	W1023059	3	6 clamp straps 70-150 mm ²	-	1 piece	2.42 kg
1.002.711	X1023060	3	6 M10 terminal screws	with electronic fuse monitoring ESÚ installed (rated voltage=525VAC)	1 piece	2.64 kg
1.000.831	T1023057	3	6 M10 terminal screws	with electro-mechanic fuse monitoring MZS installed (galvanic isolation)	1 piece	3.13 kg



1.000.405

MULTIBLOC® 1.ST8 size 1 250A, 690VAC bottom fitting, quadruple pole

CAT. NUMBER	ITEM NUMBER	POLES	CABLE TERMINATION COMPONENTS	DESIGN	PKG	WEIGHT
1.000.405	Y1023061	4	8 M10 terminal screws	-	1 piece	3.4 kg
1.002.378	V1002128	4	8 M10 terminal screws	with ready fitted special solid link as neutral conductor in pole 4 for leading and lagging switching	1 piece	3.55 kg

ACCESSORIES

Cover shields



1.000.353



1.002.351

CAT. NUMBER	ITEM NUMBER	DESIGN	PKG	WEIGHT
1.000.353	Z229884	cover shield for installation in distribution units size (width x height): 210 x 260 mm for one 1.ST8/1.RST8 triple pole	1 piece	68 g
1.002.351	X1022968	cover shield for installation in distribution units size (width x height): 230 x 283 mm for one 1.ST8/1.RST8 triple pole	1 piece	90 g

NH FUSE SWITCH DISCONNECTOR

MULTIBLOC® 1.ST8

Size 1, 250A, 690VAC, Design for Bottom Fitting, 1-,2-,3-,4-pole

ACCESSORIES

Cover/shrouds for cable termination

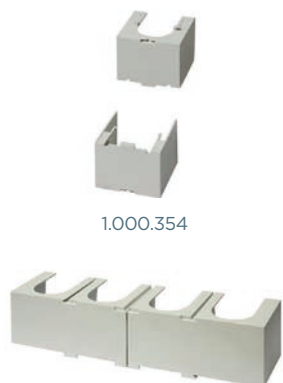

1.000.354



1.003.402



1.002.592

1.002.501

CAT. NUMBER	ITEM NUMBER	DESIGN	PKG	WEIGHT
1.000.354	W229881	cover for cable terminal connection for 1.ST8 single pole, 1 set = 2 pieces	1 set	0.19 kg
1.000.382	V229880	cover for cable terminal connection for 1.ST8 triple pole, 1 set = 2 pieces	1 set	0.29 kg
1.003.402	M1022982	cover for cable terminal connection for 1.ST8 quadruple pole	1 piece	0.13 kg
1.002.592	G1023437	bus bar touch protection for bus bar adapter size 1, 1 set = 2 pieces	1 set	0.20 kg

Adapter for installation on to bus bars with clamp terminal

CAT. NUMBER	ITEM NUMBER	DESIGN	PKG	WEIGHT
1.002.501	C1023088	bus bar adapter size 1 with clamp terminal for MULTIBLOC® 1.ST8 triple pole for bus bar system 100 mm	1 piece	1.23 kg

Installation devices



1.000.383

1.000.384

1.000.402

1.000.403

CAT. NUMBER	ITEM NUMBER	DESIGN	PKG	WEIGHT
1.000.383	E229291	adapter for installation on to DIN-rails in accordance with EN 60 715-150 mm for 1.ST8 triple pole	1 piece	3.1 kg
1.000.384	D229290	adapter for installation on to DIN-rails in accordance with EN 60 715-125 mm for 1.ST8 triple pole	1 piece	3.1 kg
1.000.402	A229885	adapter for installation on to DIN-rails in accordance with EN 60 715-125 mm for 1.ST8 single pole	1 piece	0.16 kg
1.000.403	B229886	adapter for installation on to DIN-rails in accordance with EN 60 715-150 mm for 1.ST8 single pole	1 piece	0.19 kg

Indication facilities



1.000.852

CAT. NUMBER	ITEM NUMBER	DESIGN	PKG	WEIGHT
1.000.852	Q1002285	indicator for switch door position micro switch, 1 change-over contact 5 A, 250 V	1 piece	90 g

NH FUSE SWITCH DISCONNECTOR

MULTIBLOC® 1.ST8

ACCESSORIES

Size 1, 250A, 690VAC, Design for Bottom Fitting, 1-,2-,3-,4-pole

Locking and sealing devices/cover sealing device



1.000.155

CAT. NUMBER	ITEM NUMBER	DESIGN	PKG	WEIGHT
1.000.155	L229297	cover sealing device-installation set for 00.ST8 1-, 2-, 4-pole and 1.ST8/RST8	1 piece	10 g

Locking and sealing devices/locking device for window



1.000.150

CAT. NUMBER	ITEM NUMBER	DESIGN	PKG	WEIGHT
1.000.150	K229296	locking device for window for 00.ST8 1-, 2-, 4-pole and 1/2.ST8/RST8 1 set = 3 pieces	1 set	20 g

Varieties of cable termination



1.000.420



1.001.830

CAT. NUMBER	ITEM NUMBER	DESIGN	PKG	WEIGHT
1.000.420	E229889	clamp strap 70–150 mm ² for 1.ST8 1- 4-pole + 1.RST8, 1 set = 3 pieces	1 set	0.14 kg
1.001.830	J1023117	V-shaped lug size 1, M8, for V-terminal clamp size 1 for 1.ST8 1- to 4-pole + 1.RST8, supplementary set for V-terminal with use of V-clamps 1 set = 3 pieces	1 set	90 g

MULTIBLOC® 1.RST8

PRODUCT RANGE

Size 1, 250A, 690VAC, Design for bus bar installation, Triple Pole

MULTIBLOC® 1.RST8 size 1 250A, 690VAC bus bar installation, triple pole



1.000.323



1.000.855

CAT. NUMBER	ITEM NUMBER	POLES	CABLE TERMINATION COMPONENTS	DESIGN	PKG	WEIGHT
1.000.323	T229879	3	3 M10 terminal screws	-	1 piece	3.09 kg
1.001.294	Q1023054	3	3 clamp straps 70–150 mm ²	-	1 piece	3.06 kg
1.003.134	R1023055	3	3 M10 terminal screws	with electronic fuse monitoring ESÜ installed (rated voltage = 525VAC)	1 piece	3.14 kg
1.000.855	M1023051	3	3 M10 terminal screws	with electro-mechanic fuse monitoring MZS installed (galvanic isolation)	1 piece	3.8 kg
1.000.936	P1023053	3	6 M10 terminal screws	main incomer	1 piece	4.68 kg

NH FUSE SWITCH DISCONNECTOR

MULTIBLOC® 1.RST8

Size 1, 250A, 690VAC, Design for bus bar installation, Triple Pole

ACCESSORIES



1.000.353



1.002.351

Cover shields

CAT. NUMBER	ITEM NUMBER	DESIGN	PKG	WEIGHT
1.000.353	Z229884	cover shield for installation in distribution units size [width x height]: 210 x 260 mm for one 1.ST8/1.RST8 triple pole	1 piece	68 g
1.002.351	X1022968	cover shield for installation in distribution units size [width x height]: 230 x 283 mm for one 1.ST8/1.RST8 triple pole	1 piece	90 g



1.000.382

Cover/shrouds for cable termination

CAT. NUMBER	ITEM NUMBER	DESIGN	PKG	WEIGHT
1.000.382	V229880	cover for cable terminal connection for 1.ST8 triple pole, 1 set = 2 pieces	1 set	0.29 kg
1.003.329	G1023115	bus bar touch protection for 1.RST8	1 piece	82 g



1.000.852

Indication facilities

CAT. NUMBER	ITEM NUMBER	DESIGN	PKG	WEIGHT
1.000.852	Q1002285	indicator for switch door position micro switch, 1 change-over contact 5 A, 250 V	1 piece	90 g



1.000.155

Locking and sealing devices/cover sealing device

CAT. NUMBER	ITEM NUMBER	DESIGN	PKG	WEIGHT
1.000.155	L229297	cover sealing device-installation set for 00.ST8 1-, 2-, 4-pole and 1.ST8/RST8	1 piece	10 g



1.000.150

Locking and sealing devices/locking device for window

CAT. NUMBER	ITEM NUMBER	DESIGN	PKG	WEIGHT
1.000.150	K229296	locking device for window for 00.ST8 1-, 2-, 4-pole and 1/2.ST8/RST8 1 set = 3 pieces	1 set	20 g



1.000.420

Varieties of cable termination

CAT. NUMBER	ITEM NUMBER	DESIGN	PKG	WEIGHT
1.000.420	E229889	clamp strap 70–150 mm ² for 1.ST8 1- 4-pole + 1.RST8, 1 set = 3 pieces	1 set	0.14 kg
1.001.830	J1023117	V-shaped lug size 1, M8, for V-terminal clamp size 1 for 1.ST8 1- to 4-pole + 1.RST8, supplementary set for V-terminal with use of V-clamps 1 set = 3 pieces	1 set	90 g



1.001.830

NH FUSE SWITCH DISCONNECTOR

MULTIBLOC® 2.ST8

PRODUCT RANGE

Size 2, 400A, 690VAC, Design for Bottom Fitting, 3-,4-pole



1.000.504



1.002.712



1.001.688

MULTIBLOC® 2.ST8 size 2 400A, 690VAC bottom fitting, triple pole

CAT. NUMBER	ITEM NUMBER	POLES	CABLE TERMINATION COMPONENTS	DESIGN	PKG	WEIGHT
1.000.504	W1002129	3	6 M10 terminal screws	-	1 piece	3.5 kg
1.001.240	F1023068	3	3 clamp straps 120–240 mm ² 3 M10 terminal screws	-	1 piece	3.5 kg
1.002.563	G1023069	3	6 clamp straps 120–240 mm ²	-	1 piece	3.5 kg
1.002.712	H1023070	3	6 M10 terminal screws	with electronic fuse monitoring ESÜ installed (rated voltage=525VAC)	1 piece	3.6 kg
1.000.832	E1023067	3	6 M10 terminal screws	with electro-mechanic fuse monitoring MZS installed (galvanic isolation)	1 piece	4.25 kg

MULTIBLOC® 2.ST8 size 2 400A, 690VAC bottom fitting, quadruple pole

CAT. NUMBER	ITEM NUMBER	POLES	CABLE TERMINATION COMPONENTS	DESIGN	PKG	WEIGHT
1.001.688	J1023071	4	8 M10 terminal screws	-	1 piece	5.04 kg
1.002.379	Y1002131	4	8 M10 terminal screws	with ready fitted special solid link as neutral conductor in pole 4 for leading and lagging switching	1 piece	5.26 kg

ACCESSORIES



1.000.863

Cover shields

CAT. NUMBER	ITEM NUMBER	DESIGN	PKG	WEIGHT
1.000.863	V1002174	cover shield for installation in distribution units size (width x height): 230 x 300 mm for one 2.ST8/2.RST8 triple pole	1 piece	0.10 kg
1.002.352	Y1022969	cover shield for installation in distribution units size (width x height): 234 x 310 mm for one 2.ST8/2.RST8 triple pole	1 piece	0.11 kg



1.003.255

Cover/shrouds for cable termination

CAT. NUMBER	ITEM NUMBER	DESIGN	PKG	WEIGHT
1.003.255	K1022980	cover for cable terminal connection for 2.ST8 quadruple pole	1 piece	0.16 kg
1.000.861	N1002168	cover for cable terminal connection for 2.ST8 triple pole, 1 set = 2 pieces	1 set	0.31 kg
1.002.593	J1023439	bus bar touch protection for bus bar adapter size 2, 1 set = 2 pieces	1 set	0.26 kg



1.002.593

NH FUSE SWITCH DISCONNECTOR

MULTIBLOC® 2.ST8

ACCESSORIES

Size 2, 400A, 690VAC, Design for Bottom Fitting, 3-,4-pole



1.002.502

Adapter für installation on to bus bars with clamp terminal

CAT. NUMBER	ITEM NUMBER	DESIGN	PKG	WEIGHT
1.002.502	C1023111	bus bar adapter size 2 with clamp terminal for MULTIBLOC® 2.ST8 triple pole for bus bar system 100 mm	1 piece	1.25 kg



1.000.852

Indication facilities

CAT. NUMBER	ITEM NUMBER	DESIGN	PKG	WEIGHT
1.000.852	Q1002285	indicator for switch door position micro switch, 1 change-over contact 5 A, 250 V	1 piece	90 g



1.000.150

Locking and sealing devices/locking device for window

CAT. NUMBER	ITEM NUMBER	DESIGN	PKG	WEIGHT
1.000.150	K229296	locking device for window for 00.ST8 1-, 2-, 4-pole and 1/2.ST8/RST8 1 set = 3 pieces	1 set	20 g



1.001.237



13SZAV6



13SZAD6

Varieties of cable termination

CAT. NUMBER	ITEM NUMBER	DESIGN	PKG	WEIGHT
1.001.237	B1002180	clamp strap size 2 120–240 mm ² , 1 set = 3 pieces	1 set	0.26 kg
13SZAV6	K1023118	V-terminal size 1,2,3; M12, for V-terminal clamps size 1,2,3 for MULTIBLOC® size 2 supplementary set for V-terminal with use of V-clamps 1 set = 3 pieces	1 set	0.27 kg
13SZAD6	A1022971	M12 terminal lugs for M12 double terminal for MULTIBLOC® size 2 and 3 1 set = 3 pieces	1 set	0.26 kg

MULTIBLOC® 2.RST8

PRODUCT RANGE

Size 2, 400A, 690VAC, Design for bus bar installation, Triple Pole

MULTIBLOC® 2.RST8 size 2 400A, 690VAC bus bar installation, triple pole



1.003.135

CAT. NUMBER	ITEM NUMBER	POLES	CABLE TERMINATION COMPONENTS	DESIGN	PKG	WEIGHT
1.000.704	M1002167	3	3 M10 terminal screws	-	1 piece	4.77 kg
1.001.295	C1023065	3	3 clamp straps 120–240 mm ²	-	1 piece	4.61 kg
1.003.135	D1023066	3	3 M10 terminal screws	with electronic fuse monitoring ESÚ installed [rated voltage = 525VAC]	1 piece	4.6 kg
1.000.856	Z1023062	3	3 M10 terminal screws	with electro-mechanic fuse monitoring MZS installed [galvanic isolation]	1 piece	5.28 kg
1.001.028	A1023063	3	6 M10 terminal screws	main incomer	1 piece	5.74 kg

NH FUSE SWITCH DISCONNECTOR

MULTIBLOC® 2.RST8

ACCESSORIES

Size 2, 400A, 690VAC, Design for bus bar installation, Triple Pole



1.000.863

Cover shields

CAT. NUMBER	ITEM NUMBER	DESIGN	PKG	WEIGHT
1.000.863	V1002174	cover shield for installation in distribution units size (width x height): 230 x 300 mm for one 2.ST8/2.RST8 triple pole	1 piece	0.10 kg
1.002.352	Y1022969	cover shield for installation in distribution units size (width x height): 234 x 310 mm for one 2.ST8/2.RST8 triple pole	1 piece	0.11 kg



1.003.347

Cover/shrouds for cable termination

CAT. NUMBER	ITEM NUMBER	DESIGN	PKG	WEIGHT
1.000.861	N1002168	cover for cable terminal connection for 2.ST8 triple pole, 1 set = 2 pieces	1 set	0.31 kg
1.003.347	H1023116	bus bar touch protection for 2.RST8	1 piece	97 g



1.000.852

Indication facilities

CAT. NUMBER	ITEM NUMBER	DESIGN	PKG	WEIGHT
1.000.852	Q1002285	indicator for switch door position micro switch, 1 change-over contact 5 A, 250 V	1 piece	90 g



1.000.150

Locking and sealing devices/locking device for window

CAT. NUMBER	ITEM NUMBER	DESIGN	PKG	WEIGHT
1.000.150	K229296	locking device for window for 00.ST8 1-, 2-, 4-pole and 1./2.ST8/RST8 1 set = 3 pieces	1 set	20 g



1.001.237



13SZAV6



13SZAD6

Varieties of cable termination

CAT. NUMBER	ITEM NUMBER	DESIGN	PKG	WEIGHT
1.001.237	B1002180	clamp strap size 2 120–240 mm ² , 1 set = 3 pieces	1 set	0.26 kg
13SZAV6	K1023118	V-terminal size 1,2,3; M12, for V-terminal clamps size 1,2,3 for MULTIBLOC® size 2 supplementary set for V-terminal with use of V-clamps 1 set = 3 pieces	1 set	0.27 kg
13SZAD6	A1022971	M12 terminal lugs for M12 double terminal for MULTIBLOC® size 2 and 3 1 set = 3 pieces	1 set	0.26 kg

NH FUSE SWITCH DISCONNECTOR

MULTIBLOC® 3.ST8

PRODUCT RANGE

Size 3, 630A, 690VAC, Design for Bottom Fitting, 3-,4-pole

MULTIBLOC® 3.ST8 size 3 630A, 690VAC bottom fitting, triple pole



1.001.125



1.002.713

CAT. NUMBER	ITEM NUMBER	POLES	CABLE TERMINATION COMPONENTS	DESIGN	PKG	WEIGHT
1.001.125	C1002135	3	6 M12 terminal screws	-	1 piece	4.94 kg
1.001.241	L1023073	3	3 clamp straps 150–300 mm ² 3 M12 terminal screws	-	1 piece	5.13 kg
1.002.713	M1023074	3	6 M12 terminal screws	with electronic fuse monitoring ESU installed (rated voltage=525VAC)	1 piece	5.5 kg
1.001.150	K1023072	3	6 M12 terminal screws	with electro-mechanic fuse monitoring MZS installed (galvanic isolation)	1 piece	5.74 kg



1.001.904

MULTIBLOC® 3.ST8 size 3 630A, 690VAC bottom fitting, quadruple pole

CAT. NUMBER	ITEM NUMBER	POLES	CABLE TERMINATION COMPONENTS	DESIGN	PKG	WEIGHT
1.001.904	N1023075	4	8 M12 terminal screws	-	1 piece	7.44 kg
1.002.661	P1023076	4	8 M12 terminal screws	with ready fitted special solid link as neutral conductor in pole 4 for leading and lagging switching	1 piece	7.71 kg

ACCESSORIES



1.002.353

Cover shields

CAT. NUMBER	ITEM NUMBER	DESIGN	PKG	WEIGHT
1.002.353	W1002175	cover shield for installation in distribution units size (width x height): 287 x 330 mm for one 3.ST8 triple pole	1 piece	0.13 kg



1.000.893

Cover/shrouds for cable termination

CAT. NUMBER	ITEM NUMBER	DESIGN	PKG	WEIGHT
1.000.893	P1002169	cover for cable terminal connection for 3.ST8 triple pole, 1 set = 2 pieces	1 set	0.50 kg
1.003.319	L1022981	cover for cable terminal connection for 3.ST8 quadruple pole	1 piece	0.25 kg



1.003.319

NH FUSE SWITCH DISCONNECTOR

MULTIBLOC® 3.ST8

Size 3, 630A, 690VAC, Design for Bottom Fitting, 3-,4-pole

ACCESSORIES



1.002.490

Adapter für installation on to bus bars with clamp terminal

CAT. NUMBER	ITEM NUMBER	DESIGN	PKG	WEIGHT
1.002.490	D1023112	bus bar adapter size 3 with clamp terminal for MULTIBLOC® 3.ST8 triple pole for bus bar system 60 mm	1 piece	1.17 kg
1.002.503	E1023113	bus bar adapter size 3 with clamp terminal for MULTIBLOC® 3.ST8 triple pole for bus bar system 100 mm	1 piece	1.28 kg



1.000.852

Indication facilities

CAT. NUMBER	ITEM NUMBER	DESIGN	PKG	WEIGHT
1.000.852	Q1002285	indicator for switch door position micro switch, 1 change-over contact 5 A, 250 V	1 piece	90 g



1.001.238

Varieties of cable termination

CAT. NUMBER	ITEM NUMBER	DESIGN	PKG	WEIGHT
1.001.238	C1002181	clamp strap size 3 150–300 mm², 1 set = 3 pieces	1 set	0.32 kg
13SZAD6	A1022971	M12 terminal lugs for M12 double terminal for MULTIBLOC® size 2 and 3 1 set = 3 pieces	1 set	0.26 kg

NH FUSE SWITCH DISCONNECTOR

MULTIBLOC® 4a.ST8

PRODUCT RANGE

Size 4a, 400VAC, 1250A, Design for Bottom Fitting, 1-, 3-pole



1.000.083

MULTIBLOC® 4a.ST8 size 4a 1250A, 400VAC bottom fitting, single pole

CAT. NUMBER	ITEM NUMBER	POLES	CABLE TERMINATION COMPONENTS	PKG	WEIGHT
1.000.083	T1023080	1	M16 terminal screws	1 piece	4.1 kg



1.000.089

MULTIBLOC® 4a.ST8 size 4a 1250A, 400VAC bottom fitting, triple pole

CAT. NUMBER	ITEM NUMBER	POLES	CABLE TERMINATION COMPONENTS	DESIGN	PKG	WEIGHT
1.000.089	V1023081	3	M16 terminal screws	single pole switching	1 piece	12.5 kg
1.000.090	W1023082	3	M16 terminal screws	triple pole switching	1 piece	12.5 kg

MULTIBLOC® 4a.ST8

Size 4a, 690VAC, 1600A, 690VAC, Design for Bottom Fitting, 1-, 3-pole



1.000.084

MULTIBLOC® 4a.ST8 size 4a 1600A, 690VAC bottom fitting, single pole

CAT. NUMBER	ITEM NUMBER	POLES	CABLE TERMINATION COMPONENTS	PKG	WEIGHT
1.000.084	X1023083	1	2xM12 terminal screws	1 piece	5 kg



1.000.091

MULTIBLOC® 4a.ST8 size 4a 1600A, 690VAC bottom fitting, triple pole

CAT. NUMBER	ITEM NUMBER	POLES	CABLE TERMINATION COMPONENTS	DESIGN	PKG	WEIGHT
1.000.091	Y1023084	3	2xM12 terminal screws	single pole switching	1 piece	13.7 kg
1.000.092	Z1023085	3	2xM12 terminal screws	triple pole switching	1 piece	13.9 kg

NH VERTICAL FUSE SWITCH DISCONNECTOR

MULTIVERT®

In accordance with IEC/EN 60 947-3.

For NH-fuse links in accordance with IEC/EN 60 269-2, VDE 0636-2.

- From size 00 (160A) up to size 4a (1600A) ratings
- Installation on to bus bar systems (60mm, 100mm, 185mm)
- Design for bottom or top cable terminal connection
- Touch protection IP30 with central cover
- Parking position of switch operating cover even with fuse links inserted
- Varieties of cable termination: screw, clamp strap, AlCu clamp, frame clamp, V-terminal
- Electronic or electro-mechanic fuse monitoring optional
- Variants for parallel connection or specific application (main incomer, transformer incomer)
- Various accessories: indicator for switch door position, Current Transformers pre-mounted in factory or delivered separately...



MULTIVERT	POLE SWITCHING		BUSBAR SYSTEM SIZE		
	NH-VERTICAL	1X TRIPLE POLE	3X SINGLE POLE	60 MM	100 MM
Size 00	•		•	•	•
Size 1	•	•			•
Size 2	•	•			•
Size 3	•	•			•
Size 4a		•			•

NH VERTICAL FUSE SWITCH DISCONNECTOR

MULTIVERT® 160A/60mm

Size 00, 690VAC, Triple Pole Switching

PRODUCT RANGE

MULTIVERT® 160 A size 00 60 mm bus bar system 1 x triple pole switching



1.000.909

CAT. NUMBER	ITEM NUMBER	CABLE TERMINATION COMPONENTS	DESIGN	PKG	WEIGHT
1.000.909	E1002183	3 M8 terminal screws/3 clamp straps 4-70 mm ²	bottom terminal with cover shroud MZ00KH	1 piece	1.45 kg
1.002.489	Z1023154	3 frame clamps Cu 2,5-70 mm ²	bottom terminal with cover shroud MZ00KH	1 piece	1.3 kg
1.003.140	A1023155	3 M8 terminal screws/3 clamp straps 4-70 mm ²	bottom terminal MULTIVERT® 1.000.909 with cabling of instrument leads	1 piece	1.5 kg
1.003.307	C1023157	3 M8 terminal screws/3 clamp straps 4-70 mm ²	top terminal with cover shroud MZ00KH	1 piece	1.5 kg
1.003.308	D1023158	3 M8 terminal screws/3 clamp straps 4-70 mm ²	top terminal MULTIVERT® 1.003.307 with cabling of instrument leads	1 piece	1.5 kg
1.003.309	E1023159	3 frame clamps Cu 2,5-70 mm ²	top terminal with cover shroud MZ00KH	1 piece	1.3 kg

ACCESSORIES



MZ00KH



MZ00KA

Cover/shrouds for cable termination

CAT. NUMBER	ITEM NUMBER	DESIGN	PKG	WEIGHT
MZ00KH	F1023298	cover shroud length 106 mm for MULTIVERT®/BSL 160 A	1 piece	20 g
MZ00KA	L1023464	extended cover shroud for cover shroud MZ00KH	1 piece	40 g
1.000.915	H1023300	cover shroud for MULTIVERT®/BSL 160 A with V-terminal	1 piece	50 g



MZAW

Covers/level & system adjustment covers

CAT. NUMBER	ITEM NUMBER	DESIGN	PKG	WEIGHT
MZ00AAD	X214081	2 piece adjustment, with integrated area for labeling to adapt to MULTIVERT® for 185 mm bus bar system	1 set	0.1 kg
MZAW	D218687	support angle for support of cover plate 1 set = 4 pieces	1 set	27 g

NH VERTICAL FUSE SWITCH DISCONNECTOR

MULTIVERT® 160A/60mm

Size 00, 690VAC, Triple Pole Switching

ACCESSORIES



1.002.939



1.000.852

Indication facilities

CAT. NUMBER	ITEM NUMBER	DESIGN	PKG	WEIGHT
1.002.939	Y1023452	electronic fuse monitoring ESÜ size 00 for MULTIVERT® 160 A with cabling of instrument leads (rated voltage 525VAC)	1 piece	0.66 kg
1.000.852	Q1002285	indicator for switch door position micro switch, 1 change-over contact 5 A, 250 V	1 piece	90 g



1.000.107



1.000.101

Amperemeter units

CAT. NUMBER	ITEM NUMBER	DESIGN	PKG	WEIGHT
1.000.106	R1023285	size 00, 100 A, with drag indicator, triple pole measurement (optional L1, L2, L3)	1 piece	0.34 kg
1.000.107	S1023286	size 00, 150 A, with drag indicator, triple pole measurement (optional L1, L2, L3)	1 piece	0.34 kg
1.000.100	K1023279	size 00, 100 A, with drag indicator, single pole measurement	1 piece	0.34 kg
1.000.101	L1023280	size 00, 150 A, with drag indicator, single pole measurement	1 piece	0.34 kg



MZ00BT2

Labelling facilities

CAT. NUMBER	ITEM NUMBER	DESIGN	PKG	WEIGHT
MZ00BT2	K215611	label holder size 00	1 piece	10 g

Varieties of cable termination



O0SZS



O0SZESK



1.003.433



O0SZVK1



1.000.098

CAT. NUMBER	ITEM NUMBER	DESIGN	PKG	WEIGHT
O0SZS	M229298	M8 terminal screw for switch gear size 00 1 set = 3 pieces	1 set	35 g
O0SZESK	E214594	clamp strap Cu 4-70 mm² for switch gear size 00 1 set = 3 pieces	1 set	35 g
O0SZA70	R211523	Al/Cu clamp 1,5-70 mm² for switch gear size 00 1 set = 3 pieces	1 set	75 g
1.003.571	V1033684	Al/Cu clamp 50-95 mm² round stranded for switch gear size 00 1 set = 3 pieces	1 set	88 g
1.003.433	L1022958	triple clamp per pole 1.5 up to 16 mm² 1 set = 3 pieces	1 set	0.14 kg
O0SZVK1	D1023434	V-terminal clamp size 00, 10-70 mm² round stranded, 10-95 mm² round solid, 35-95 mm² single stranded, 50-95 mm² single solid, M = 12 Nm	30	0.4 kg
1.000.098	E1023435	insulation cap for V-terminal clamp size 00	12/120	2 g

NH VERTICAL FUSE SWITCH DISCONNECTOR

MULTIVERT® 160A

PRODUCT RANGE

Size 00, 690VAC, Triple Pole Switching

MULTIVERT® 160 A size 00 100 mm bus bar system 1 x triple pole switching



1.000.900 1.000.903



1.000.905

CAT. NUMBER	ITEM NUMBER	CABLE TERMINATION COMPONENTS	DESIGN	PKG	WEIGHT
1.000.900	F1002184	3 M8 terminal screws	with cover shroud MZ00KH	1 piece	1.12 kg
1.000.901	X1023129	3 clamp straps Cu 4-70 mm ²	with cover shroud MZ00KH	1 piece	1.12 kg
1.000.902	Z1023131	3 Al/Cu clamps 1,5-70 mm ²	with cover shroud MZ00KH	1 piece	1.12 kg
1.000.903	A1023132	with V-terminal for V-terminal clamps size 00	with cover shroud 1.000.915	1 piece	1.12 kg
1.000.904	B1023133	3 frame clamps Cu 2,5-70 mm ²	with cover shroud MZ00KH	1 piece	1.1 kg
1.000.905	G1002185	3 M8 terminal screws	MULTIVERT® 1.000.900 with cabling of instrument leads	1 piece	1.47 kg
1.000.906	C1023134	3 clamp straps Cu 4-70 mm ²	MULTIVERT® 1.000.901 with cabling of instrument leads	1 piece	1.47 kg
1.000.907	D1023135	3 Al/Cu clamps 1,5-70 mm ²	MULTIVERT® 1.000.902 with cabling of instrument leads	1 piece	1.47 kg
1.000.908	E1023136	with V-terminal for V-terminal clamps size 00	MULTIVERT® 1.000.903 with cabling of instrument leads	1 piece	1.47 kg
1.002.437	Y1023130	3 frame clamps Cu 2,5-70 mm ²	MULTIVERT® 1.000.904 with cabling of instrument leads	1 piece	1.18 kg

MULTIVERT® 160 A size 00 185 mm bus bar system 1 x triple pole switching



1.001.339

CAT. NUMBER	ITEM NUMBER	CABLE TERMINATION COMPONENTS	DESIGN	PKG	WEIGHT
1.001.339	Y1023153	3 M8 terminal screws	including adjustment cover art.no. MZ00AAD and adapter 1.001.298	1 piece	1.8 kg

ACCESSORIES

Cover/shrouds for cable termination



MZ00KH



MZ00KA

CAT. NUMBER	ITEM NUMBER	DESIGN	PKG	WEIGHT
MZ00KH	F1023298	cover shroud length 106 mm for MULTIVERT®/BSL 160 A	1 piece	20 g
MZ00KA	L1023464	extended cover shroud for cover shroud MZ00KH	1 piece	40 g
1.000.915	H1023300	cover shroud for MULTIVERT®/BSL 160 A with V-terminal	1 piece	50 g

NH VERTICAL FUSE SWITCH DISCONNECTOR

MULTIVERT® 160A

Size 00, 690VAC, Triple Pole Switching

ACCESSORIES



MZAW

Covers/level & system adjustment covers

CAT. NUMBER	ITEM NUMBER	DESIGN	PKG	WEIGHT
MZ00AAD	X214081	2 piece adjustment, with integrated area for labeling to adapt to MULTIVERT® for 185 mm bus bar system	1 set	0.1 kg
MZAW	D218687	support angle for support of cover plate 1 set = 4 pieces	1 set	27 g



MZ00LPAP



MZ01LPAP



1.002.493

Covers/spare way covers

CAT. NUMBER	ITEM NUMBER	DESIGN	APPLICATION	PKG	WEIGHT
MZ00LPAP	B1023409	spare way cover without level adjustment width 50 mm, length 320 mm for single adapter MZ00ESA and double adapter MZ00DSA including fixing material	bus bar system 100 mm	1 piece	50 g
MZ01LPAP	C1023410	spare way cover without level adjustment width 50 mm, length 500 mm including fixing material	bus bar system 185 mm	1 piece	60 g
1.002.493	N1002283	spare way cover width 50 mm, length 630 mm for covering of open installation spaces in distribution units with central cover	bus bar system 185 mm	1 piece	0.14 kg
1.002.830	E1023412	spare way cover width 50 mm, length 630 mm with level adjustment 123 mm for bus bar installation, set = cover + fixing set [2 distance pieces, 2 screw rivets]	bus bar system 185 mm	1 set	0.20 kg



1.002.830



OOSZRK3



1.002.646

Installation devices/bus bar installation

CAT. NUMBER	ITEM NUMBER	DESIGN	PKG	WEIGHT
OOSZRK3	K215105	hooked clamp size 00, M = 5 Nm 1 set = 3 pieces	1 set	0.10 kg
1.002.646	W1023450	M10 insert nut, size 00 1 set = 30 pieces	1 set	0.12 kg

NH VERTICAL FUSE SWITCH DISCONNECTOR

MULTIVERT® 160A

Size 00, 690VAC, Triple Pole Switching

ACCESSORIES



1.001.289 1.001.298

Adapter für installation on to bus bars with clamp terminal

CAT. NUMBER	ITEM NUMBER	DESIGN	APPLICATION	PKG	WEIGHT
1.001.289	C1023295	single adapter 100/185 mm with increased touch protection to obtain uniform profile in height for combined installation with MULTIVERT 250 A, 400 A, 630 A	MULTIVERT® 160 A/100 mm 1x3-pole	1 piece	0.56 kg
1.001.298	Y1023291	double adapter 100/185 mm with increased touch protection to obtain uniform profile in height for combined installation with MULTIVERT 250 A, 400 A, 630 A	MULTIVERT® 160 A/100 mm 1x3-pole	1 piece	0.8 kg



MZ00DSA MZ00ESA MZ00ESAECO

Adapter für installation on to bus bars with screw terminal

CAT. NUMBER	ITEM NUMBER	DESIGN	APPLICATION	PKG	WEIGHT
MZ00DSA	C217145	double adapter 100/185 mm with increased touch protection to obtain uniform profile in height for combined installation with MULTIVERT®/BSL 250 A, 400 A, 630 A	MULTIVERT® 160 A/100 mm 1x3-pole	1 piece	0.71 kg
MZ00ESA	Q216628	single adapter 100/185 mm with increased touch protection to obtain uniform profile in height for combined installation with MULTIVERT®/BSL 250 A, 400 A, 630 A	MULTIVERT® 160 A/100 mm 1x3-pole	1 piece	0.51 kg
MZ00ESAECO	D1023296	Single adapter 100/185 mm to obtain uniform profile in height for combined installation with MULTIVERT®/BSL 250 A, 400 A, 630 A	MULTIVERT® 160 A/100 mm 1x3-pole	1 piece	0.19 kg

Indication facilities

CAT. NUMBER	ITEM NUMBER	DESIGN	PKG	WEIGHT
1.002.939	Y1023452	electronic fuse monitoring ESÜ size 00 for MULTIVERT® 160 A with cabling of instrument leads (rated voltage 525VAC)	1 piece	0.66 kg
1.000.852	Q1002285	indicator for switch door position micro switch, 1 change-over contact 5 A, 250 V	1 piece	90 g



1.002.939



1.000.852

NH VERTICAL FUSE SWITCH DISCONNECTOR

MULTIVERT® 160A

Size 00, 690VAC, Triple Pole Switching

ACCESSORIES



1.000.107



1.000.101

Amperemeter units

CAT. NUMBER	ITEM NUMBER	DESIGN	PKG	WEIGHT
1.000.106	R1023285	size 00, 100 A, with drag indicator, triple pole measurement (optional L1, L2, L3)	1 piece	0.34 kg
1.000.107	S1023286	size 00, 150 A, with drag indicator, triple pole measurement (optional L1, L2, L3)	1 piece	0.34 kg
1.000.100	K1023279	size 00, 100 A, with drag indicator, single pole measurement	1 piece	0.34 kg
1.000.101	L1023280	size 00, 150 A, with drag indicator, single pole measurement	1 piece	0.34 kg



1.000.119 +
1.000.123



1.000.120 +
1.000.124

Current transformers in combination with adapter

CAT. NUMBER	ITEM NUMBER	DESIGN	PKG	WEIGHT
1.000.121	F1024609	current transformer for adapter for single pole measurement up to 100/5A, class 1 set = 1 piece current transformer + 3 pieces distance tubes art.no. 1.000.125 for level adjustment, 1 piece installed, 2 pieces additionally packed	1 set	0.51 kg
1.000.123	H1024611	current transformer for adapter for single pole measurement up to 150/5A, class 1 set = 1 piece current transformer + 3 pieces distance tubes art.no. 1.000.125 for level adjustment, 1 piece installed, 2 pieces additionally packed	1 set	0.52 kg
1.000.122	G1024610	current transformer for adapter for triple pole measurement up to 100/5A, class 1 set = 3 pieces current transformer with distance tubes art.no. 1.000.125 for level adjustment 3 pieces installed	1 set	0.78 kg
1.000.124	J1024612	current transformer for adapter for triple pole measurement up to 150/5A, class 1 set = 3 pieces current transformer with distance tubes art.no. 1.000.125 for level adjustment 3 pieces installed	1 set	0.81 kg
1.000.125	V1024599	distance tube for adapter for level adjustment supplementary set for neighbouring MULTIVERT® without measurement to obtain uniform profile in height 1 set = 3 pieces	1 set	0.37 kg
1.000.117	R1023446	single adapter 100/185 mm for circuit transformer	1 piece	0.34 kg
1.000.119	A1023293	double adapter 100/185 mm for circuit transformer	1 piece	0.58 kg
1.000.120	B1023294	double adapter 185/185 mm for circuit transformer	1 piece	0.56 kg

NH VERTICAL FUSE SWITCH DISCONNECTOR

MULTIVERT® 160A

Size 00, 690VAC, Triple Pole Switching

ACCESSORIES



MZ003SW100



SZ1SW150



MZ00PR150



MZ00BT2

Current transformers/external current transformers

CAT. NUMBER	ITEM NUMBER	DESIGN	PKG	WEIGHT
MZ001SW100	C1024606	current transformer up to 100 A for single pole measurement between bus bar and MULTIVERT® set = 1 piece current transformer + 3 pieces distance tubes for level adjustment, 1 piece installed in the current transformer, 2 pieces additionally packed	1 set	0.55 kg
MZ001SW150	E1024608	current transformer up to 150 A for single pole measurement between bus bar and MULTIVERT® set = 1 piece current transformer + 3 pieces distance tubes for level adjustment, 1 piece installed in the current transformer, 2 pieces additionally packed	1 set	0.55 kg
MZ003SW100	B1024605	current transformer up to 100/5A for triple pole measurement between bus bar and MULTIVERT®, class 1 set = 3 pieces current transformer with distance tubes for level adjustment, 3 pieces installed in the current transformer	1 set	1.84 kg
MZ003SW150	D1024607	current transformer up to 150/5A for triple pole measurement between bus bar and MULTIVERT®, class 1 set = 3 pieces current transformer with distance tubes for level adjustment, 3 pieces installed in the current transformer	1 set	1.85 kg
SZ1SW100	H1024565	current transformer up to 100/5A for single pole measurement between bus bars, class 1 (incoming and outgoing bar)	1 piece	0.32 kg
SZ1SW150	J1024566	current transformer up to 150/5A for single pole measurement between bus bars, class 1 (incoming and outgoing bar)	1 piece	0.33 kg
MZ00PR150	R1024596	distance tube for level adjustment, up to 150/5A, supplementary set for neighbouring MULTIVERT® without measurement to obtain uniform profile in height 1 set = 3 pieces	1 set	0.4 kg

Labelling facilities

CAT. NUMBER	ITEM NUMBER	DESIGN	PKG	WEIGHT
MZ00BT2	K215611	label holder size 00	1 piece	10 g

NH VERTICAL FUSE SWITCH DISCONNECTOR

MULTIVERT® 160A

Size 00, 690VAC, Triple Pole Switching

ACCESSORIES

Varieties of cable termination



00SZS

00SZESK



1.003.433



00SZVK1



1.000.098

CAT. NUMBER	ITEM NUMBER	DESIGN	PKG	WEIGHT
00SZS	M229298	M8 terminal screw for switch gear size 00 1 set = 3 pieces	1 set	35 g
00SZESK	E214594	clamp strap Cu 4–70 mm ² for switch gear size 00 1 set = 3 pieces	1 set	35 g
00SZA70	R211523	Al/Cu clamp 1,5–70 mm ² for switch gear size 00 1 set = 3 pieces	1 set	75 g
1.003.571	V1033684	Al/Cu clamp 50–95 mm ² round stranded for switch gear size 00 1 set = 3 pieces	1 set	88 g
1.003.433	L1022958	triple clamp per pole 1.5 up to 16 mm ² 1 set = 3 pieces	1 set	140 g
00SZVK1	D1023434	V-terminal clamp size 00, 10–70 mm ² round stranded, 10–95 mm ² round solid, 35–95 mm ² single stranded, 50–95 mm ² single solid, M = 12 Nm	30	400 g
1.000.098	E1023435	insulation cap for V-terminal clamp size 00	12/120	2 g

NH VERTICAL FUSE SWITCH DISCONNECTOR

MULTIVERT® 160A/185mm

Size 00, 690VAC, single pole switching

PRODUCT RANGE

MULTIVERT® 160 A size 00 185 mm 3 x single pole switching



M01NOG 1.001.725

CAT. NUMBER	ITEM NUMBER	CABLE TERMINATION COMPONENTS	DESIGN	PKG	WEIGHT
M01NOG	Y228756	3 M8 terminal screws	with cover shroud MZ00KH	1 piece	1.9 kg
M01S0G	X1023152	3 clamp straps Cu 4-70 mm ²	with cover shroud MZ00KH	1 piece	1.9 kg
M01A0G	Q1023146	3 Al/Cu clamps 1,5-70 mm ²	with cover shroud MZ00KH	1 piece	1.9 kg
1.000.910	G1023138	with V-terminal for V-terminal clamps size 00	with cover shroud 1.000.915	1 piece	1.9 kg
1.001.725	M1023143	V-terminal with 3 V-terminal clamps size 00	with cover shroud 1.000.915	1 piece	1.1 kg
M01NOE11G	R1023147	3 M8 terminal screws	MULTIVERT® M01NOG with cabling of instrument leads	1 piece	2.25 kg
M01S0E11G	W1023151	3 clamp straps Cu 4-70 mm ²	MULTIVERT® M01S0G with cabling of instrument leads	1 piece	2.25 kg
M01A0E11G	P1023145	3 Al/Cu clamps 1,5-70 mm ²	MULTIVERT® M01A0G with cabling of instrument leads	1 piece	2.25 kg
1.000.911	L1023142	with V-terminal for V-terminal clamps size 00	MULTIVERT® 1.000.910 with cabling of instrument leads	1 piece	2.25 kg



M01NOE11G

NH VERTICAL FUSE SWITCH DISCONNECTOR

MULTIVERT® 160A/185mm

Size 00, 690VAC, single pole switching

ACCESSORIES



MZ00KH



MZ00KA



MZ00KAD



MZ01AS



MZAW



MZ01LPAP



1.002.493



1.002.830



O0SZRK3



1.002.646

Cover/shrouds for cable termination

CAT. NUMBER	ITEM NUMBER	DESIGN	PKG	WEIGHT
MZ00KH	F1023298	cover shroud length 106 mm for MULTIVERT®/BSL 160 A	1 piece	20 g
MZ00KA	L1023464	extended cover shroud for cover shroud MZ00KH	1 piece	40 g
1.000.915	H1023300	cover shroud for MULTIVERT®/BSL 160 A with V-terminal	1 piece	50 g
MZ00KAD	G1023299	cover shroud length 156 mm for MULTIVERT®/BSL 160 A	1 piece	60 g

Covers/level & system adjustment covers

CAT. NUMBER	ITEM NUMBER	DESIGN	PKG	WEIGHT
MZ01AS	F228763	adjustment to adapt to MULTIVERT® 250 A, 400 A, 630 A (top terminal)	1 piece	10 g
MZAW	D218687	support angle for support of cover plate 1 set = 4 pieces	1 set	27 g

Covers/spare way covers

CAT. NUMBER	ITEM NUMBER	DESIGN	APPLICATION	PKG	WEIGHT
MZ01LPAP	C1023410	spare way cover without level adjustment width 50 mm, length 500 mm including fixing material	bus bar system 185 mm	1 piece	60 g
1.002.493	N1002283	spare way cover width 50 mm, length 630 mm for covering of open installation spaces in distribution units with central cover	bus bar system 185 mm	1 piece	140 g
1.002.830	E1023412	spare way cover width 50 mm, length 630 mm with level adjustment 123 mm for bus bar installation, set = cover + fixing set (2 distance pieces, 2 screw rivets)	bus bar system 185 mm	1 set	200 g

Installation devices/bus bar installation

CAT. NUMBER	ITEM NUMBER	DESIGN	PKG	WEIGHT
O0SZRK3	K215105	hooked clamp size 00, M = 5 Nm 1 set = 3 pieces	1 set	100 g
1.002.646	W1023450	M10 insert nut, size 00 1 set = 30 pieces	1 set	120 g

NH VERTICAL FUSE SWITCH DISCONNECTOR

MULTIVERT® 160A/185mm

Size 00, 690VAC, single pole switching

ACCESSORIES



1.001.300

Adapter für installation on to bus bars with clamp terminal

CAT. NUMBER	ITEM NUMBER	DESIGN	APPLICATION	PKG	WEIGHT
1.001.300	Z1023292	double adapter 185/185 mm with increased touch protection to obtain uniform profile in height for combined installation with MULTIVERT® 250 A, 400 A, 630 A	MULTIVERT® 160 A/185 mm 3x1-pole	1 piece	0.75 kg



MZ01DSA MZ01ESA

Adapter für installation on to bus bars with screw terminal

CAT. NUMBER	ITEM NUMBER	DESIGN	APPLICATION	PKG	WEIGHT
MZ01DSA	G228764	double adapter 185/185 mm with increased touch protection to obtain uniform profile in height for combined installation with MULTIVERT®/BSL 250 A, 400 A, 630 A	MULTIVERT® 160 A/185 mm 1x3-pole	1 piece	0.7 kg
MZ01ESA	H228765	single adapter 185/185 mm (for installation of MULTIVERT®/BSL with screws M8) to obtain uniform profile in height for combined installation with MULTIVERT®/BSL 250 A, 400 A, 630 A	MULTIVERT® 160 A/185 mm 1x3-pole	1 piece	0.39 kg

Indication facilities



1.002.939



3 x MZHD

CAT. NUMBER	ITEM NUMBER	DESIGN	PKG	WEIGHT
1.002.939	Y1023452	electronic fuse monitoring ESÜ size 00 for MULTIVERT® 160 A with cabling of instrument leads (rated voltage 525VAC)	1 piece	0.66 kg
MZHD	M1023442	indicator for switch door position 1 "a" contact/ 1 "b" contact, 5 A, 250 V for MULTIVERT® 160 A/bus bar system 185 mm 3 x single pole switching	1 piece	0.01 kg

NH VERTICAL FUSE SWITCH DISCONNECTOR

MULTIVERT® 160A/185mm

Size 00, 690VAC, single pole switching

ACCESSORIES



1.000.107



1.000.101

Amperemeter units

CAT. NUMBER	ITEM NUMBER	DESIGN	PKG	WEIGHT
1.000.106	R1023285	size 00, 100 A, with drag indicator, triple pole measurement (optional L1, L2, L3)	1 piece	0.34 kg
1.000.107	S1023286	size 00, 150 A, with drag indicator, triple pole measurement (optional L1, L2, L3)	1 piece	0.34 kg
1.000.100	K1023279	size 00, 100 A, with drag indicator, single pole measurement	1 piece	0.34 kg
1.000.101	L1023280	size 00, 150 A, with drag indicator, single pole measurement	1 piece	0.34 kg



1.000.119 +
1.000.123



1.000.120 +
1.000.124

Current transformers in combination with adapter

CAT. NUMBER	ITEM NUMBER	DESIGN	PKG	WEIGHT
1.000.121	F1024609	current transformer for adapter for single pole measurement up to 100/5A, class 1 set = 1 piece current transformer + 3 pieces distance tubes art.no. 1.000.125 for level adjustment, 1 piece installed, 2 pieces additionally packed	1 set	0.51 kg
1.000.123	H1024611	current transformer for adapter for single pole measurement up to 150/5A, class 1 set = 1 piece current transformer + 3 pieces distance tubes art.no. 1.000.125 for level adjustment, 1 piece installed, 2 pieces additionally packed	1 set	0.52 kg
1.000.122	G1024610	current transformer for adapter for triple pole measurement up to 100/5A, class 1 set = 3 pieces current transformer with distance tubes art.no. 1.000.125 for level adjustment 3 pieces installed	1 set	0.78 kg
1.000.124	J1024612	current transformer for adapter for triple pole measurement up to 150/5A, class 1 set = 3 pieces current transformer with distance tubes art.no. 1.000.125 for level adjustment 3 pieces installed	1 set	0.81 kg
1.000.125	V1024599	distance tube for adapter for level adjustment supplementary set for neighbouring MULTIVERT® without measurement to obtain uniform profile in height 1 set = 3 pieces	1 set	0.37 kg
1.000.117	R1023446	single adapter 100/185 mm for circuit transformer	1 piece	0.34 kg
1.000.119	A1023293	double adapter 100/185 mm for circuit transformer	1 piece	0.58 kg
1.000.120	B1023294	double adapter 185/185 mm for circuit transformer	1 piece	0.56 kg

NH VERTICAL FUSE SWITCH DISCONNECTOR

MULTIVERT® 160A/185mm

Size 00, 690VAC, single pole switching

ACCESSORIES



MZ003SW100



SZ1SW150



MZ00PR150

Current transformers/external current transformers

CAT. NUMBER	ITEM NUMBER	DESIGN	PKG	WEIGHT
MZ001SW100	C1024606	current transformer up to 100 A for single pole measurement between bus bar and MULTIVERT® set = 1 piece current transformer + 3 pieces distance tubes for level adjustment, 1 piece installed in the current transformer, 2 pieces additionally packed	1 set	0.55 kg
MZ001SW150	E1024608	current transformer up to 150 A for single pole measurement between bus bar and MULTIVERT® set = 1 piece current transformer + 3 pieces distance tubes for level adjustment, 1 piece installed in the current transformer, 2 pieces additionally packed	1 set	0.55 kg
MZ003SW100	B1024605	current transformer up to 100/5A for triple pole measurement between bus bar and MULTIVERT®, class 1 set = 3 pieces current transformer with distance tubes for level adjustment, 3 pieces installed in the current transformer	1 set	1.84 kg
MZ003SW150	D1024607	current transformer up to 150/5A for triple pole measurement between bus bar and MULTIVERT®, class 1 set = 3 pieces current transformer with distance tubes for level adjustment, 3 pieces installed in the current transformer	1 set	1.85 kg
SZ1SW100	H1024565	current transformer up to 100/5A for single pole measurement between bus bars, class 1 (incoming and outgoing bar)	1 piece	0.32 kg
SZ1SW150	J1024566	current transformer up to 150/5A for single pole measurement between bus bars, class 1 (incoming and outgoing bar)	1 piece	0.33 kg
MZ00PR150	R1024596	distance tube for level adjustment, up to 150/5A, supplementary set for neighbouring MULTIVERT® without measurement to obtain uniform profile in height 1 set = 3 pieces	1 set	0.4 kg



MZ00BT2

Labelling facilities

CAT. NUMBER	ITEM NUMBER	DESIGN	PKG	WEIGHT
MZ00BT2	K215611	label holder size 00	1 piece	10 g

NH VERTICAL FUSE SWITCH DISCONNECTOR

MULTIVERT® 160A/185mm

Size 00, 690VAC, single pole switching

ACCESSORIES

Varieties of cable termination



OOSZS

OOSZESK



1.003.433



OOSZVK1



1.000.098

CAT. NUMBER	ITEM NUMBER	DESIGN	PKG	WEIGHT
OOSZS	M229298	M8 terminal screw for switch gear size 00 1 set = 3 pieces	1 set	35 g
OOSZESK	E214594	clamp strap Cu 4–70 mm ² for switch gear size 00 1 set = 3 pieces	1 set	35 g
OOSZA70	R211523	Al/Cu clamp 1,5–70 mm ² for switch gear size 00 1 set = 3 pieces	1 set	75 g
1.003.571	V1033684	Al/Cu clamp 50–95 mm ² round stranded for switch gear size 00 1 set = 3 pieces	1 set	88 g
1.003.433	L1022958	triple clamp per pole 1.5 up to 16 mm ² 1 set = 3 pieces	1 set	140 g
OOSZVK1	D1023434	V-terminal clamp size 00, 10–70 mm ² round stranded, 10–95 mm ² round solid, 35–95 mm ² single stranded, 50–95 mm ² single solid, M = 12 Nm	30	400 g
1.000.098	E1023435	insulation cap for V-terminal clamp size 00	12/120	2 g

MULTIVERT® 250A

Size 1, 690VAC

PRODUCT RANGE

MULTIVERT® 250 A size 1 185 mm 3 x single pole switching



1.100.000

CAT. NUMBER	ITEM NUMBER	CABLE TERMINATION COMPONENTS	DESIGN	PKG	WEIGHT
1.100.000	H1002186	3 M10 bolts	-	1 piece	4.52 kg
1.110.000	J1023163	3 M10 insert nuts	-	1 piece	4.46 kg
1.120.000	K1023164	V-terminal for V-terminal clamps size 1,2,3	-	1 piece	4.38 kg
1.120.900	Q1023169	V-terminal, 2 terminals per phase for V-terminal clamps size 1,2,3	-	1 piece	5.5 kg
1.100.083	N1023167	3 M10 bolts	MULTIVERT® 1.100.000 with integrated C.T. 250/5A, 3,75 VA, class 1 for single pole measurement (ready fitted in pole 1)	1 piece	4.6 kg
1.100.062	L1023165	3 M10 bolts	MULTIVERT® 1.100.000 with integrated C.T. 250/5A, 3,75 VA, class 0,5; calibrated, for single pole measurement (ready fitted in pole 1)	1 piece	4.6 kg
1.100.093	P1023168	3 M10 bolts	MULTIVERT® 1.100.000 with integrated C.T. 250/5A, 3,50 VA, class 1 for triple pole measurement	1 piece	5.3 kg
1.100.072	M1023166	3 M10 bolts	MULTIVERT® 1.100.000 with integrated C.T. 250/5A, 3,50 VA, class 0,5; calibrated, for triple pole measurement	1 piece	4.6 kg

NH VERTICAL FUSE SWITCH DISCONNECTOR

MULTIVERT® 250A

Size 1, 690VAC

PRODUCT RANGE

MULTIVERT® 250 A size 1 185 mm 1 x triple pole switching



1.150.000 1.170.000

CAT. NUMBER	ITEM NUMBER	CABLE TERMINATION COMPONENTS	DESIGN	PKG	WEIGHT
1.150.000	L1002189	3 M10 bolts	-	1 piece	4.67 kg
1.160.000	S1023171	3 M10 insert nuts	-	1 piece	4.63 kg
1.170.000	H1023185	V-terminal for V-terminal clamps size 1,2,3	-	1 piece	4.55 kg
1.170.600	K1023187	V-terminal with 3 terminal clamps size 1,2,3	-	1 piece	4.6 kg
1.170.900	M1023189	V-terminal, 2 terminals per phase for V-terminal clamps size 1,2,3	-	1 piece	5.8 kg
1.150.100	P1002192	3 M10 bolts	MULTIVERT® 1.150.000 with cabling of instrument leads for indication facilities	1 piece	5.1 kg
1.150.083	R1023193	3 M10 bolts	MULTIVERT® 1.150.000 with integrated C.T. 250/5A, 3,75 VA, class 1 for single pole measurement (ready fitted in pole 1)	1 piece	4.8 kg
1.150.062	N1023190	3 M10 bolts	MULTIVERT® 1.150.000 with integrated C.T. 250/5A, 3,75 VA, class 0,5; calibrated, for single pole measurement (ready fitted in pole 1)	1 piece	4.8 kg
1.150.091	S1023194	3 M10 bolts	MULTIVERT® 1.150.000 with integrated C.T. 100/5A, 2,00 VA, class 1 for triple pole measurement	1 piece	5.4 kg
1.150.093	T1023195	3 M10 bolts	MULTIVERT® 1.150.000 with integrated C.T. 250/5A, 3,50 VA, class 1 for triple pole measurement	1 piece	5.4 kg
1.150.072	P1023191	3 M10 bolts	MULTIVERT® 1.150.000 with integrated C.T. 250/5A, 3,50 VA, class 0,5; calibrated, for triple pole measurement	1 piece	4.8 kg

NH VERTICAL FUSE SWITCH DISCONNECTOR

MULTIVERT® 250A

Size 1, 690VAC

ACCESSORIES



Cover/shrouds for cable termination

CAT. NUMBER	ITEM NUMBER	DESIGN	APPLI-CATION	PKG	WEIGHT
1.002.095	J1002279	cover shroud for extended cover length 70 mm	bottom terminal	1 piece	0.12 kg
1.002.458	N1023305	cover shroud for multiple termination length 205,5mm	bottom terminal	1 piece	0.16 kg
MZKAB	J1023301	cover shroud for clamp terminal connection in feeder pillars length 138,5 mm	top terminal	1 piece	0.10 kg
MZKHO	G217655	cover shroud for cable terminal connections with cable lugs on switchboards with central cover length 190 mm	top terminal	1 piece	0.13 kg
MZKAB1	K1023302	cover shroud for special (high) clamp terminal connection in feeder pillars length 138,5 mm	top terminal	1 piece	0.12 kg
MZVHB	L1023303	extended cover shroud length 257 mm	top terminal	1 piece	0.23 kg
MZKHV	A1002202	cover shroud for installation in distribution units with central cover (height of supporting edge reduced by 16 mm) length 145 mm	top terminal	1 piece	0.09 kg

Covers/level & system adjustment covers

CAT. NUMBER	ITEM NUMBER	DESIGN	PKG	WEIGHT
1.001.510	K1002280	cover shield to support central cover 1 set = 2 pieces	1 set	0.15 kg
MZAW	D218687	support angle for support of cover plate 1 set = 4 pieces	1 set	0.03 kg

NH VERTICAL FUSE SWITCH DISCONNECTOR

MULTIVERT® 250A

Size 1, 690VAC

ACCESSORIES



MZO1LPAP MZLPAP 1.002.493



1.002.492 1.002.830 1.002.829



1.002.647



1.000.192

Covers/spare way covers

CAT. NUMBER	ITEM NUMBER	DESIGN	APPLICATION	PKG	WEIGHT
MZO1LPAP	C1023410	spare way cover without level adjustment width 50 mm, length 500 mm including fixing material	bus bar system 185 mm	1 piece	0.06 kg
MZLPAP	D1023411	spare way cover width 100 mm, length 612 mm including 2 pieces M12 fixing screws (distance of fixing holes 185 mm)	bus bar system 185 mm	1 piece	0.12 kg
1.002.493	N1002283	spare way cover width 50 mm, length 630 mm for covering of open installation spaces in distribution units with central cover	bus bar system 185 mm	1 piece	0.14 kg
1.002.492	M1002282	spare way cover width 100 mm, length 630 mm for covering of open installation spaces in distribution units with central cover	bus bar system 185 mm	1 piece	0.20 kg
1.002.830	E1023412	spare way cover width 50 mm, length 630 mm with level adjustment 123 mm for bus bar installation, set = cover + fixing set (2 distance pieces, 2 screw rivets)	bus bar system 185 mm	1 set	0.20 kg
1.002.829	F1023413	spare way cover width 100 mm, length 630 mm with level adjustment 123 mm for bus bar installation set = cover + fixing set (2 distance pieces, 2 screw rivets)	bus bar system 185 mm	1 set	0.27 kg

Installation devices/bus bar installation

CAT. NUMBER	ITEM NUMBER	DESIGN	PKG	WEIGHT
1.002.647	S1023447	M10 insert nut, size 1 1 set = 30 pieces	1 set	0.19 kg
1.000.192	P1002284	hooked clamp size 1, 2, 3, M = 15–20 Nm hexagon socket connection (inbus) for MULTIVERT®/BSL with top or bottom terminal 1 set = 3 pieces	1 set	0.47 kg

NH VERTICAL FUSE SWITCH DISCONNECTOR

MULTIVERT® 250A

Size 1, 690VAC

ACCESSORIES



1.002.940



1.000.829



1.000.852

Indication facilities

CAT. NUMBER	ITEM NUMBER	DESIGN	PKG	WEIGHT
1.002.940	Z1023453	electronic fuse monitoring ESÜ size 1,2,3 for MULTIVERT® 250 A, 400 A, 630 A with cabling of instrument leads (rated voltage 525VAC)	1 piece	0.85 kg
1.000.829	L1023418	electro-mechanical fuse monitoring (galvanic isolation) MZS size 1,2,3 for MULTIVERT® 250 A, 400 A, 630 A with cabling of instrument leads	1 piece	0.31 kg
1.000.852	Q1002285	indicator for switch door position micro switch, 1 change-over contact 5 A, 250 V	1 piece	90 g



1.000.102

Amperemeter units

CAT. NUMBER	ITEM NUMBER	DESIGN	PKG	WEIGHT
1.000.102	M1023281	size 1, 2, 3, 250 A, with drag indicator, single pole measurement	1 piece	83 g
1.000.108	T1023287	size 1, 2, 3, 250 A, with drag indicator, triple pole measurement (optional L1, L2, L3)	1 piece	83 g



MZPR600

Current transformers/external current transformers

CAT. NUMBER	ITEM NUMBER	DESIGN	PKG	WEIGHT
MZ1SW250	K1024567	current transformer up to 250/5A for single pole measurement, class 1 set = 1 piece current transformer + 3 pieces distance tubes for level adjustment, 1 piece installed in the current transformer, 2 pieces additionally packed	1 set	0.88 kg
MZ3SW250	M1024569	current transformer up to 250/5A for triple pole measurement, class 1 set = 3 pieces current transformer with distance tubes for level adjustment, 3 pieces installed in the current transformer	1 set	1.38 kg
SZ1SW250	L1024568	current transformer up to 250/5A, class 1, for single pole measurement	1 piece	0.43 kg
MZPR600	S1024597	distance tube for level adjustment, up to 600/5A, supplementary set for neighbouring MULTIVERT® without measurement to obtain uniform profile in height 1 set = 3 pieces	1 set	0.62 kg



MZBT

Labelling facilities

CAT. NUMBER	ITEM NUMBER	DESIGN	PKG	WEIGHT
MZBT	B222181	label holder size 1, 2, 3	1 piece	30 g

NH VERTICAL FUSE SWITCH DISCONNECTOR

MULTIVERT® 250A

Size 1, 690VAC

ACCESSORIES



1.002.909



1.002.910



22SZVK42



1.000.099



1.003.286



1.001.667



1.003.377



1.002.255

Varieties of cable termination

CAT. NUMBER	ITEM NUMBER	DESIGN	PKG	WEIGHT
1.002.909	K1024613	V-terminal clamp size 1,2,3, 95-240 mm ² single solid, 70-240 mm ² single stranded, 50-185 mm ² round stranded, 70-240 mm ² round solid, M = 23 -27 Nm 1 set = 3 pieces	1 set	0.24 kg
1.002.910	L1024614	V-terminal clamp size 1,2,3, 95-300 mm ² single solid, 70-240 mm ² single stranded, 50-185 mm ² round stranded, 70-240 mm ² round solid, M = 23 -27 Nm 1 set = 3 pieces	1 set	0.26 kg
22SZVK42	Q1024618	V-terminal clamp size 1,2,3 for 2 conductors 50-240 mm ² single solid, 50-185 mm ² single stranded, 50-185 mm ² round stranded, 70-240 mm ² round solid M = 23-27 Nm	1 piece	0.17 kg
1.000.099	E1023436	insulation cap for V-terminal clamp size 1,2,3	1 piece	0.01 kg
1.003.286	Q1024595	supplementary set for V-terminal size 1,2,3 set = 3 pieces V-clamps, cover shroud and labels for size 1, 2 and 3	1 set	0.23 kg
1.001.667	F1023275	adapter for double terminal L3	1 piece	0.25 kg
1.003.377	Y1024579	supplementary set for multiple termination, top terminal 2 cable lugs Cu/Al: up to max. 300 mm ² round stranded, sectoral stranded, 3 cable lugs Cu: up to max. 150 mm ² round stranded, sectoral stranded, M = 32-38 Nm	1 set	1.74 kg
1.002.255	B1024582	supplementary set for multiple termination, bottom terminal 2 cable lugs Cu/Al: up to max. 300 mm ² round stranded, sectoral stranded, 3 cable lugs Cu: up to max. 150 mm ² round stranded, sectoral stranded, M = 32-38 Nm	1 set	1.68 kg

NH VERTICAL FUSE SWITCH DISCONNECTOR

MULTIVERT® 400A

Size 2, 690VAC

PRODUCT RANGE

MULTIVERT® 400 A size 2 185 mm 3 x single pole switching



1.200.000 1.220.000

CAT. NUMBER	ITEM NUMBER	CABLE TERMINATION COMPONENTS	DESIGN	PKG	WEIGHT
1.200.000	J1002187	3 M12 bolts	-	1 piece	4.6 kg
1.210.000	Z1023200	3 M12 insert nuts	-	1 piece	4.52 kg
1.220.000	A1023201	V-terminal for V-terminal clamps size 1,2,3	-	1 piece	4.38 kg
1.220.900	B1023202	V-terminal, 2 terminals per phase for V-terminal clamps size 1,2,3	-	1 piece	5.45 kg
1.200.100	Y1023199	3 M12 bolts	MULTIVERT® 1.200.000 with cabling of instrument leads for indication facilities	1 piece	5.1 kg
1.200.084	E1023205	3 M12 bolts	MULTIVERT® 1.200.000 with integrated C.T. 400/5A, 3,75 VA, class 1 for single pole measurement (ready fitted in pole 1)	1 piece	4.7 kg
1.200.064	C1023203	3 M12 bolts	MULTIVERT® 1.200.000 with integrated C.T. 400/5A, 3,75 VA, class 0,5; calibrated, for single pole measurement (ready fitted in pole 1)	1 piece	4.7 kg
1.200.094	F1023206	3 M12 bolts	MULTIVERT® 1.200.000 with integrated C.T. 400/5A, 3,75 VA, class 1 for triple pole measurement	1 piece	5.4 kg
1.200.074	D1023204	3 M12 bolts	MULTIVERT® 1.200.000 with integrated C.T. 400/5A, 3,75 VA, class 0,5; calibrated, for triple pole measurement	1 piece	4.7 kg
1.230.000	T1023218	M12 bus bar terminal	MULTIVERT® with lateral bus bar terminals bus bar coupler switch cable terminal connection to right or left side possible	1 piece	4.46 kg

NH VERTICAL FUSE SWITCH DISCONNECTOR

MULTIVERT® 400A

Size 2, 690VAC

PRODUCT RANGE

MULTIVERT® 400 A size 2 185 mm 1 x triple pole switching



1.250.000 1.270.000



1.270.094
rear

CAT. NUMBER	ITEM NUMBER	CABLE TERMINATION COMPONENTS	DESIGN	PKG	WEIGHT
1.250.000	M1002190	3 M12 bolts	-	1 piece	4.76 kg
1.260.000	G1023207	3 M12 insert nuts	-	1 piece	4.68 kg
1.270.000	H1023208	V-terminal for V-terminal clamps size 1,2,3	-	1 piece	4.78 kg
1.270.600	K1023210	V-terminal + 3 V-terminal clamps size 1,2,3	-	1 piece	4.7 kg
1.270.900	L1023211	V-terminal, 2 terminals per phase for V-terminal clamps size 1,2,3	-	1 piece	6.08 kg
1.250.100	X1002199	3 M12 bolts	MULTIVERT® 1.250.000 with cabling of instrument leads for indication facilities	1 piece	5.2 kg
1.270.100	J1023209	V-terminal for V-terminal clamps size 1,2,3	MULTIVERT® 1.270.000 with cabling of instrument leads for indication facilities	1 piece	5.1 kg
1.250.084	P1023214	3 M12 bolts	MULTIVERT® 1.250.000 with integrated C.T. 400/5A, 3,75 VA, class 1 for single pole measurement (ready fitted in pole 1)	1 piece	4.9 kg
1.250.064	M1023212	3 M12 bolts	MULTIVERT® 1.250.000 with integrated C.T. 400/5A, 3,75 VA, class 0,5; calibrated, for single pole measurement (ready fitted in pole 1)	1 piece	4.9 kg
1.250.094	Q1023215	3 M12 bolts	MULTIVERT® 1.250.000 with integrated C.T. 400/5A, 3,75 VA, class 1 for triple pole measurement	1 piece	5.6 kg
1.250.074	N1023213	3 M12 bolts	MULTIVERT® 1.250.000 with integrated C.T. 400/5A, 3,75 VA, class 0,5; calibrated, for triple pole measurement	1 piece	4.9 kg
1.270.094	S1023217	V-terminal for V-terminal clamps size 1,2,3	MULTIVERT® 1.270.000 with integrated C.T. 400/5A, 3,75 VA, class 1 for triple pole measurement	1 piece	5.41 kg
1.270.074	R1023216	V-terminal for V-terminal clamps size 1,2,3	MULTIVERT® 1.270.000 with integrated C.T. 400/5A, 3,75 VA, class 0,5; calibrated, for triple pole measurement	1 piece	4.9 kg
1.280.000	V1023219	M12 bus bar terminal	MULTIVERT® with lateral bus bar terminals bus bar coupler switch cable terminal connection to right or left side possible	1 piece	4.53 kg

NH VERTICAL FUSE SWITCH DISCONNECTOR

MULTIVERT® 400A

Size 2, 690VAC

ACCESSORIES



1.002.095



1.002.458



MZKAB



MZKHO



MZKAB1



MZVHB



MZKHV



1.001.510



MZAW

Cover/shrouds for cable termination

CAT. NUMBER	ITEM NUMBER	DESIGN	APPLI-CATION	PKG	WEIGHT
1.002.095	J1002279	cover shroud for extended cover length 70 mm	bottom terminal	1 piece	0.12 kg
1.002.458	N1023305	cover shroud for multiple termination length 205,5mm	bottom terminal	1 piece	0.16 kg
MZKAB	J1023301	cover shroud for clamp terminal connection in feeder pillars length 138,5 mm	top terminal	1 piece	0.10 kg
MZKHO	G217655	cover shroud for cable terminal connections with cable lugs on switchboards with central cover length 190 mm	top terminal	1 piece	0.13 kg
MZKAB1	K1023302	cover shroud for special (high) clamp terminal connection in feeder pillars length 138,5 mm	top terminal	1 piece	0.12 kg
MZVHB	L1023303	extended cover shroud length 257 mm	top terminal	1 piece	0.23 kg
MZKHV	A1002202	cover shroud for installation in distribution units with central cover (height of supporting edge reduced by 16 mm) length 145 mm	top terminal	1 piece	0.09 kg

Covers/level & system adjustment covers

CAT. NUMBER	ITEM NUMBER	DESIGN	PKG	WEIGHT
1.001.510	K1002280	cover shield to support central cover 1 set = 2 pieces	1 set	0.15 kg
MZAW	D218687	support angle for support of cover plate 1 set = 4 pieces	1 set	0.03 kg

NH VERTICAL FUSE SWITCH DISCONNECTOR

MULTIVERT® 400A

Size 2, 690VAC

ACCESSORIES



MZO1LPAP MZLPAP 1.002.493



1.002.492 1.002.830 1.002.829



1.002.648



1.000.192

Covers/spare way covers

CAT. NUMBER	ITEM NUMBER	DESIGN	APPLICATION	PKG	WEIGHT
MZO1LPAP	C1023410	spare way cover without level adjustment width 50 mm, length 500 mm including fixing material	bus bar system 185 mm	1 piece	60 g
MZLPAP	D1023411	spare way cover width 100 mm, length 612 mm including 2 pieces M12 fixing screws (distance of fixing holes 185 mm)	bus bar system 185 mm	1 piece	0.56 kg
1.002.493	N1002283	spare way cover width 50 mm, length 630 mm for covering of open installation spaces in distribution units with central cover	bus bar system 185 mm	1 piece	0.14 kg
1.002.492	M1002282	spare way cover width 100 mm, length 630 mm for covering of open installation spaces in distribution units with central cover	bus bar system 185 mm	1 piece	0.20 kg
1.002.830	E1023412	spare way cover width 50 mm, length 630 mm with level adjustment 123 mm for bus bar installation, set = cover + fixing set (2 distance pieces, 2 screw rivets)	bus bar system 185 mm	1 set	0.20 kg
1.002.829	F1023413	spare way cover width 100 mm, length 630 mm with level adjustment 123 mm for bus bar installation set = cover + fixing set (2 distance pieces, 2 screw rivets)	bus bar system 185 mm	1 set	0.27 kg

Installation devices/bus bar installation

CAT. NUMBER	ITEM NUMBER	DESIGN	PKG	WEIGHT
1.002.648	T1023448	M12 insert nut, size 2 and 3 1 set = 30 pieces	1 set	0.28 kg
1.000.192	P1002284	hooked clamp size 1, 2, 3, M = 15–20 Nm hexagon socket connection (inbus) for MULTIVERT®/BSL with top or bottom terminal 1 set = 3 pieces	1 set	0.47 kg

NH VERTICAL FUSE SWITCH DISCONNECTOR

MULTIVERT® 400A

Size 2, 690VAC

ACCESSORIES



1.002.940



1.000.829



1.000.852

Indication facilities

CAT. NUMBER	ITEM NUMBER	DESIGN	PKG	WEIGHT
1.002.940	Z1023453	electronic fuse monitoring ESÜ size 1,2,3 for MULTIVERT® 250 A, 400 A, 630 A with cabling of instrument leads (rated voltage 525VAC)	1 piece	0.85 kg
1.000.829	L1023418	electro-mechanical fuse monitoring (galvanic isolation) MZS size 1,2,3 for MULTIVERT® 250 A, 400 A, 630 A with cabling of instrument leads	1 piece	0.31 kg
1.000.852	Q1002285	indicator for switch door position micro switch, 1 change-over contact 5 A, 250 V	1 piece	90 g



1.000.102



1.000.103



1.000.109

Amperemeter units

CAT. NUMBER	ITEM NUMBER	DESIGN	PKG	WEIGHT
1.000.102	M1023281	size 1, 2, 3, 250 A, with drag indicator, single pole measurement	1 piece	83 g
1.000.103	N1023282	size 2, 3, 400 A, with drag indicator, single pole measurement	1 piece	83 g
1.000.108	T1023287	size 1, 2, 3, 250 A, with drag indicator, triple pole measurement (optional L1, L2, L3)	1 piece	83 g
1.000.109	V1023288	size 2, 3, 400 A, with drag indicator, triple pole measurement (optional L1, L2, L3)	1 piece	83 g



1.002.294



1.002.295

Amperemeter for direct frontal installation

CAT. NUMBER	ITEM NUMBER	DESIGN	PKG	WEIGHT
1.002.294	G1023276	size 2/3, 400 / 200 / 5A, with drag indicator, for NH-measuring fuse link, single pole measurement	1 piece	0.14 kg
1.002.295	H1023277	size 2/3, 600 / 300 / 5A, with drag indicator, for NH-measuring fuse link, single pole measurement	1 piece	0.14 kg

NH VERTICAL FUSE SWITCH DISCONNECTOR

MULTIVERT® 400A

Size 2, 690VAC

ACCESSORIES



MZ3SW400



MZPR600

Current transformers/external current transformers

CAT. NUMBER	ITEM NUMBER	DESIGN	PKG	WEIGHT
MZ1SW250	K1024567	current transformer up to 250/5A for single pole measurement, class 1 set = 1 piece current transformer + 3 pieces distance tubes for level adjustment, 1 piece installed in the current transformer, 2 pieces additionally packed	1 set	0.88 kg
MZ1SW400	N1024570	current transformer up to 400/5A for single pole measurement, class 1 set = 1 piece current transformer + 3 pieces distance tubes for level adjustment, 1 piece installed in the current transformer, 2 pieces additionally packed	1 set	0.89 kg
MZ3SW250	M1024569	current transformer up to 250/5A for triple pole measurement, class 1 set = 3 pieces current transformer with distance tubes for level adjustment, 3 pieces installed in the current transformer	1 set	1.38 kg
MZ3SW400	Q1024572	current transformer up to 400/5A for triple pole measurement, class 1 set = 3 pieces current transformer with distance tubes for level adjustment, 3 pieces installed in the current transformer	1 set	1.43 kg
SZ1SW250	L1024568	current transformer up to 250/5A, class 1, for single pole measurement	1 piece	0.43 kg
SZ1SW400	P1024571	current transformer up to 400/5A, class 1, for single pole measurement	1 piece	0.46 kg
MZPR600	S1024597	distance tube for level adjustment, up to 600/5A, supplementary set for neighbouring MULTIVERT® without measurement to obtain uniform profile in height 1 set = 3 pieces	1 set	0.62 kg



MZBT

Labelling facilities

CAT. NUMBER	ITEM NUMBER	DESIGN	PKG	WEIGHT
MZBT	B222181	label holder size 1, 2, 3	1 piece	30 g

NH VERTICAL FUSE SWITCH DISCONNECTOR

MULTIVERT® 400A

Size 2, 690VAC

ACCESSORIES



1.002.909



1.002.910



22SZVK42



1.000.099



1.003.286



1.001.667



1.003.377



1.002.255

Varieties of cable termination

CAT. NUMBER	ITEM NUMBER	DESIGN	PKG	WEIGHT
1.002.909	K1024613	V-terminal clamp size 1,2,3, 95-240 mm ² single solid, 70-240 mm ² single stranded, 50-185 mm ² round stranded, 70-240 mm ² round solid, M = 23 -27 Nm 1 set = 3 pieces	1 set	0.24 kg
1.002.910	L1024614	V-terminal clamp size 1,2,3, 95-300 mm ² single solid, 70-240 mm ² single stranded, 50-185 mm ² round stranded, 70-240 mm ² round solid, M = 23 -27 Nm 1 set = 3 pieces	1 set	0.26 kg
22SZVK42	Q1024618	V-terminal clamp size 1,2,3 for 2 conductors 50-240 mm ² single solid, 50-185 mm ² single stranded, 50-185 mm ² round stranded, 70-240 mm ² round solid M = 23-27 Nm	1 piece	6.8 g
1.000.099	E1023436	insulation cap for V-terminal clamp size 1,2,3	1 piece	0.1 g
1.003.286	Q1024595	supplementary set for V-terminal size 1,2,3 set = 3 pieces V-clamps, cover shroud and labels for size 1, 2 and 3	1 set	0.23 kg
1.001.667	F1023275	adapter for double terminal L3	1 piece	0.25 kg
1.003.377	Y1024579	supplementary set for multiple termination, top terminal 2 cable lugs Cu/Al: up to max. 300 mm ² round stranded, sectoral stranded, 3 cable lugs Cu: up to max. 150 mm ² round stranded, sectoral stranded, M = 32-38 Nm	1 set	1.74 kg
1.002.255	B1024582	supplementary set for multiple termination, bottom terminal 2 cable lugs Cu/Al: up to max. 300 mm ² round stranded, sectoral stranded, 3 cable lugs Cu: up to max. 150 mm ² round stranded, sectoral stranded, M = 32-38 Nm	1 set	1.68 kg

NH VERTICAL FUSE SWITCH DISCONNECTOR

MULTIVERT® 630A

Size 3, 690VAC

PRODUCT RANGE

MULTIVERT® 630 A size 3 185mm 3 x single pole switching



1.300.000 1.320.000

CAT. NUMBER	ITEM NUMBER	CABLE TERMINATION COMPONENTS	DESIGN	PKG	WEIGHT
1.300.000	K1002188	3 M12 bolts	-	1 piece	5.43 kg
1.310.000	W1023220	3 M12 insert nuts	-	1 piece	5.38 kg
1.320.000	X1023221	V-terminal for V-terminal clamps size 1,2,3	-	1 piece	5.21 kg
1.320.900	Y1023222	V-terminal, 2 terminals per phase for V-terminal clamps size 1,2,3	-	1 piece	6.89 kg
1.300.100	W1027153	3 M12 bolts	MULTIVERT® 1.200.000 with cabling of instrument leads for indication facilities	1 piece	5.1 kg
1.300.085	A1023247	3 M12 bolts	MULTIVERT® 1.300.000 with integrated C.T. 600/5A, 5,00 VA, class 1 for single pole measurement [ready fitted in pole 1]	1 piece	5.6 kg
1.300.066	Z1023223	3 M12 bolts	MULTIVERT® 1.300.000 with integrated C.T. 600/5A, 5,00 VA, class 0,5; calibrated, for single pole measurement [ready fitted in pole 1]	1 piece	5.6 kg
1.300.095	B1023248	3 M12 bolts	MULTIVERT® 1.300.000 with integrated C.T. 600/5A, 5,00 VA, class 1 for triple pole measurement	1 piece	6.3 kg
1.300.076	Z1023246	3 M12 bolts	MULTIVERT® 1.300.000 with integrated C.T. 600/5A, 5,00 VA, class 0,5; calibrated, for triple pole measurement	1 piece	5.6 kg
1.330.000	Q1023261	M12 bus bar terminal	MULTIVERT® with lateral bus bar terminals bus bar coupler switch cable terminal connection to right or left side possible	1 piece	6.1 kg

NH VERTICAL FUSE SWITCH DISCONNECTOR

MULTIVERT® 630A

Size 3, 690VAC

PRODUCT RANGE

MULTIVERT® 630 A size 3 185 mm 1 x triple pole switching



1.350.000 1.370.000

CAT. NUMBER	ITEM NUMBER	CABLE TERMINATION COMPONENTS	DESIGN	PKG	WEIGHT
1.350.000	N1002191	3 M12 bolts	-	1 piece	5.59 kg
1.360.000	C1023249	3 M12 insert nuts	-	1 piece	5.52 kg
1.370.000	D1023250	V-terminal for V-terminal clamps size 1,2,3	-	1 piece	5.39 kg
1.370.900	F1023252	V-terminal, 2 terminals per phase for V-terminal clamps size 1,2,3	-	1 piece	7.05 kg
1.370.600	E1023251	V-terminal + 3 V-terminal clamps	-	1 piece	5.63 kg
1.350.100	Y1002200	3 M12 bolts	MULTIVERT® 1.350.000 with cabling of instrument leads for indication facilities	1 piece	6.1 kg
1.370.100	G1023253	V-terminal for V-terminal clamps size 1,2,3	MULTIVERT® 1.370.000 with cabling of instrument leads for indication facilities	1 piece	5.9 kg
1.350.085	K1023256	3 M12 bolts	MULTIVERT® 1.350.000 with integrated C.T. 600/5A, 5,00 VA, class 1 for single pole measurement (ready fitted in pole 1)	1 piece	5.8 kg
1.350.066	H1023254	3 M12 bolts	MULTIVERT® 1.350.000 with integrated C.T. 600/5A, 5,00 VA, class 0,5; calibrated, for single pole measurement (ready fitted in pole 1)	1 piece	5.8 kg
1.350.095	L1023257	3 M12 bolts	MULTIVERT® 1.350.000 with integrated C.T. 600/5A, 5,00 VA, class 1 for triple pole measurement	1 piece	6.5 kg
1.350.076	J1023255	3 M12 bolts	MULTIVERT® 1.350.000 with integrated C.T. 600/5A, 5,00 VA, class 0,5; calibrated, for triple pole measurement	1 piece	5.8 kg
1.370.095	P1023260	V-terminal for V-terminal clamps size 1,2,3	MULTIVERT® 1.370.000 with integrated C.T. 600/5A, 5,00 VA, class 1 for triple pole measurement	1 piece	6 kg
1.370.076	M1023258	V-terminal for V-terminal clamps size 1,2,3	MULTIVERT® 1.370.000 with integrated C.T. 600/5A, 5,00 VA, class 0,5; calibrated, for triple pole measurement	1 piece	5.9 kg
1.380.000	R1023262	M12 bus bar terminal	MULTIVERT® with lateral bus bar terminals bus bar coupler switch cable terminal connection to right or left side possible	1 piece	4.77 kg

NH VERTICAL FUSE SWITCH DISCONNECTOR

MULTIVERT® 630A

Size 3, 690VAC

ACCESSORIES



1.002.095



1.002.458



MZKAB



MZKHO



MZKAB1



MZVHB



MZKHV



1.001.510



MZAW

Cover/shrouds for cable termination

CAT. NUMBER	ITEM NUMBER	DESIGN	APPLI-CATION	PKG	WEIGHT
1.002.095	J1002279	cover shroud for extended cover length 70 mm	bottom terminal	1 piece	0.12 kg
1.002.458	N1023305	cover shroud for multiple termination length 205,5mm	bottom terminal	1 piece	0.16 kg
MZKAB	J1023301	cover shroud for clamp terminal connection in feeder pillars length 138,5 mm	top terminal	1 piece	0.10 kg
MZKHO	G217655	cover shroud for cable terminal connections with cable lugs on switchboards with central cover length 190 mm	top terminal	1 piece	0.13 kg
MZKAB1	K1023302	cover shroud for special (high) clamp terminal connection in feeder pillars length 138,5 mm	top terminal	1 piece	0.12 kg
MZVHB	L1023303	extended cover shroud length 257 mm	top terminal	1 piece	0.23 kg
MZKHV	A1002202	cover shroud for installation in distribution units with central cover (height of supporting edge reduced by 16 mm) length 145 mm	top terminal	1 piece	0.09 kg

Covers/level & system adjustment covers

CAT. NUMBER	ITEM NUMBER	DESIGN	PKG	WEIGHT
1.001.510	K1002280	cover shield to support central cover 1 set = 2 pieces	1 set	0.15 kg
MZAW	D218687	support angle for support of cover plate 1 set = 4 pieces	1 set	0.03 kg

NH VERTICAL FUSE SWITCH DISCONNECTOR

MULTIVERT® 630A

Size 3, 690VAC

ACCESSORIES



MZO1LPAP MZLPAP 1.002.493



1.002.492 1.002.830 1.002.829



1.002.648



1.000.192

Covers/spare way covers

CAT. NUMBER	ITEM NUMBER	DESIGN	APPLICATION	PKG	WEIGHT
MZO1LPAP	C1023410	spare way cover without level adjustment width 50 mm, length 500 mm including fixing material	bus bar system 185 mm	1 piece	60 g
MZLPAP	D1023411	spare way cover width 100 mm, length 612 mm including 2 pieces M12 fixing screws (distance of fixing holes 185 mm)	bus bar system 185 mm	1 piece	0.56 kg
1.002.493	N1002283	spare way cover width 50 mm, length 630 mm for covering of open installation spaces in distribution units with central cover	bus bar system 185 mm	1 piece	0.14 kg
1.002.492	M1002282	spare way cover width 100 mm, length 630 mm for covering of open installation spaces in distribution units with central cover	bus bar system 185 mm	1 piece	0.20 kg
1.002.830	E1023412	spare way cover width 50 mm, length 630 mm with level adjustment 123 mm for bus bar installation, set = cover + fixing set (2 distance pieces, 2 screw rivets)	bus bar system 185 mm	1 set	0.20 kg
1.002.829	F1023413	spare way cover width 100 mm, length 630 mm with level adjustment 123 mm for bus bar installation set = cover + fixing set (2 distance pieces, 2 screw rivets)	bus bar system 185 mm	1 set	0.27 kg

Installation devices/bus bar installation

CAT. NUMBER	ITEM NUMBER	DESIGN	PKG	WEIGHT
1.002.648	T1023448	M12 insert nut, size 2 and 3 1 set = 30 pieces	1 set	0.28 kg
1.000.192	P1002284	hooked clamp size 1, 2, 3, M = 15–20 Nm hexagon socket connection (inbus) for MULTIVERT®/BSL with top or bottom terminal 1 set = 3 pieces	1 set	0.47 kg

NH VERTICAL FUSE SWITCH DISCONNECTOR

MULTIVERT® 630A

Size 3, 690VAC

ACCESSORIES



1.002.940



1.000.829



1.000.852

Indication facilities

CAT. NUMBER	ITEM NUMBER	DESIGN	PKG	WEIGHT
1.002.940	Z1023453	electronic fuse monitoring ESÚ size 1,2,3 for MULTIVERT® 250 A, 400 A, 630 A with cabling of instrument leads (rated voltage 525VAC)	1 piece	0.85 kg
1.000.829	L1023418	electro-mechanical fuse monitoring (galvanic isolation) MZS size 1,2,3 for MULTIVERT® 250 A, 400 A, 630 A with cabling of instrument leads	1 piece	0.31 kg
1.000.852	Q1002285	indicator for switch door position micro switch, 1 change-over contact 5 A, 250 V	1 piece	90 g



1.000.102



1.000.103



1.000.104



1.000.109



1.002.294



1.002.295

Amperemeter units

CAT. NUMBER	ITEM NUMBER	DESIGN	PKG	WEIGHT
1.000.102	M1023281	size 1, 2, 3, 250 A, with drag indicator, single pole measurement	1 piece	83 g
1.000.103	N1023282	size 2, 3, 400 A, with drag indicator, single pole measurement	1 piece	83 g
1.000.104	P1023283	size 3, 630 A, with drag indicator, single pole measurement	1 piece	83 g
1.000.105	J1023278	size 3, 1000 A, with drag indicator, single pole measurement	1 piece	83 g
1.000.108	T1023287	size 1, 2, 3, 250 A, with drag indicator, triple pole measurement (optional L1, L2, L3)	1 piece	83 g
1.000.109	V1023288	size 2, 3, 400 A, with drag indicator, triple pole measurement (optional L1, L2, L3)	1 piece	83 g
1.000.110	W1023289	size 3, 630 A, with drag indicator, triple pole measurement (optional L1, L2, L3)	1 piece	83 g
1.000.111	Q1023284	size 3, 1000 A, with drag indicator, triple pole measurement (optional L1, L2, L3)	1 piece	83 g

Amperemeter for direct frontal installation

CAT. NUMBER	ITEM NUMBER	DESIGN	PKG	WEIGHT
1.002.294	G1023276	size 2/3, 400 / 200 / 5A, with drag indicator, for NH-measuring fuse link, single pole measurement	1 piece	0.14 kg
1.002.295	H1023277	size 2/3, 600 / 300 / 5A, with drag indicator, for NH-measuring fuse link, single pole measurement	1 piece	0.14 kg

NH VERTICAL FUSE SWITCH DISCONNECTOR

MULTIVERT® 630A

Size 3, 690VAC

ACCESSORIES



MZ3SW400



SZ1SW600



MZPR600

Current transformers/external current transformers

CAT. NUMBER	ITEM NUMBER	DESIGN	PKG	WEIGHT
MZ1SW250	K1024567	current transformer up to 250/5A for single pole measurement, class 1 set = 1 piece current transformer + 3 pieces distance tubes for level adjustment, 1 piece installed in the current transformer, 2 pieces additionally packed	1 set	0.88 kg
MZ1SW400	N1024570	current transformer up to 400/5A for single pole measurement, class 1 set = 1 piece current transformer + 3 pieces distance tubes for level adjustment, 1 piece installed in the current transformer, 2 pieces additionally packed	1 set	0.89 kg
MZ1SW600	R1024573	current transformer up to 600/5A for single pole measurement, class 1 set = 1 piece current transformer + 3 pieces distance tubes for level adjustment, 1 piece installed in the current transformer, 2 pieces additionally packed	1 set	1.22 kg
MZ1SW1000	E1024562	current transformer up to 1000/5A for single pole measurement, class 1 set = 1 piece current transformer + 3 pieces distance tubes for level adjustment, 1 piece installed in the current transformer, 2 pieces additionally packed	1 set	1.92 kg
MZ3SW250	M1024569	current transformer up to 250/5A for triple pole measurement, class 1 set = 3 pieces current transformer with distance tubes for level adjustment, 3 pieces installed in the current transformer	1 set	1.38 kg
MZ3SW400	Q1024572	current transformer up to 400/5A for triple pole measurement, class 1 set = 3 pieces current transformer with distance tubes for level adjustment, 3 pieces installed in the current transformer	1 set	1.43 kg
MZ3SW600	T1024575	current transformer up to 600/5A for triple pole measurement, class 1 set = 3 pieces current transformer with distance tubes for level adjustment, 3 pieces installed in the current transformer	1 set	1.43 kg
MZ3SW1000	G1024564	current transformer up to 1000/5A for triple pole measurement, class 1 set = 3 pieces current transformer with distance tubes for level adjustment, 3 pieces installed in the current transformer	1 set	2.47 kg
SZ1SW250	L1024568	current transformer up to 250/5A, class 1, for single pole measurement	1 piece	0.43 kg
SZ1SW400	P1024571	current transformer up to 400/5A, class 1, for single pole measurement	1 piece	0.46 kg
SZ1SW600	S1024574	current transformer up to 600/5A, class 1, for single pole measurement	1 piece	0.4 kg
SZ1SW1000	F1024563	current transformer up to 1000/5A, class 1, for single pole measurement	1 piece	0.81 kg
MZPR600	S1024597	distance tube for level adjustment, up to 600/5A, supplementary set for neighbouring MULTIVERT® without measurement to obtain uniform profile in height 1 set = 3 pieces	1 set	0.62 kg



MZBT

Labelling facilities

CAT. NUMBER	ITEM NUMBER	DESIGN	PKG	WEIGHT
MZBT	B222181	label holder size 1, 2, 3	1 piece	30 g

NH VERTICAL FUSE SWITCH DISCONNECTOR

MULTIVERT® 630A

Size 3, 690VAC

ACCESSORIES



1.002.909



1.002.910



22SZVK42



1.000.099



1.003.286



1.001.667



1.003.377



1.002.255

Varieties of cable termination

CAT. NUMBER	ITEM NUMBER	DESIGN	PKG	WEIGHT
1.002.909	K1024613	V-terminal clamp size 1,2,3, 95-240 mm ² single solid, 70-240 mm ² single stranded, 50-185 mm ² round stranded, 70-240 mm ² round solid, M = 23 -27 Nm 1 set = 3 pieces	1 set	0.24 kg
1.002.910	L1024614	V-terminal clamp size 1,2,3, 95-300 mm ² single solid, 70-240 mm ² single stranded, 50-185 mm ² round stranded, 70-240 mm ² round solid, M = 23 -27 Nm 1 set = 3 pieces	1 set	0.26 kg
22SZVK42	Q1024618	V-terminal clamp size 1,2,3 for 2 conductors 50-240 mm ² single solid, 50-185 mm ² single stranded, 50-185 mm ² round stranded, 70-240 mm ² round solid M = 23-27 Nm	1 piece	6.8 g
1.000.099	E1023436	insulation cap for V-terminal clamp size 1,2,3	1 piece	0.1 g
1.003.286	Q1024595	supplementary set for V-terminal size 1,2,3 set = 3 pieces V-clamps, cover shroud and labels for size 1, 2 and 3	1 set	0.23 kg
1.001.667	F1023275	adapter for double terminal L3	1 piece	0.25 kg
1.003.377	Y1024579	supplementary set for multiple termination, top terminal 2 cable lugs Cu/Al: up to max. 300 mm ² round stranded, sectoral stranded, 3 cable lugs Cu: up to max. 150 mm ² round stranded, sectoral stranded, M = 32-38 Nm	1 set	1.74 kg
1.002.255	B1024582	supplementary set for multiple termination, bottom terminal 2 cable lugs Cu/Al: up to max. 300 mm ² round stranded, sectoral stranded, 3 cable lugs Cu: up to max. 150 mm ² round stranded, sectoral stranded, M = 32-38 Nm	1 set	1.68 kg

NH VERTICAL FUSE SWITCH DISCONNECTOR

MULTIVERT® 630A 4P (3P+N)

Size 3, 690VAC

PRODUCT RANGE



4.350.000

MULTIVERT® 630 A size 3 185 mm 4P (3P+N)

CAT. NUMBER	ITEM NUMBER	CABLE TERMINATION COMPONENTS	DESIGN	PKG	WEIGHT
4.350.000	G1056005	M12 bolts	4P (3P+N)	1 piece	8.9 kg
4.370.000	W1058272	V-terminal for V-clamps	4P (3P+N)	1 piece	8.9 kg
4.380.000	X1058273	M12 bus bar terminal V-terminal for N pole	4P (3P+N) MULTIVERT with lateral busbar terminals, busbar coupler switch	1 piece	6.5 kg

ACCESSORIES



1.002.095

Cover/shrouds for cable termination

CAT. NUMBER	ITEM NUMBER	DESIGN	APPLICATION	PKG	WEIGHT
1.002.095	J1002279	cover shroud for extended cover length 70 mm	bottom terminal	1 piece	0.12 kg



MZAW

Covers/level & system adjustment covers

CAT. NUMBER	ITEM NUMBER	DESIGN	PKG	WEIGHT
MZAW	D218687	support angle for support of cover plate 1 set = 4 pieces	1 set	27 g



1.000.852

Indication facilities

CAT. NUMBER	ITEM NUMBER	DESIGN	PKG	WEIGHT
1.000.852	Q1002285	indicator for switch door position micro switch, 1 change-over contact 5 A, 250 V	1 piece	90 g



MZBT

Labelling facilities

CAT. NUMBER	ITEM NUMBER	DESIGN	PKG	WEIGHT
MZBT	B222181	label holder size 1, 2, 3	1 piece	30 g



1.004.402



Varieties of cable termination

CAT. NUMBER	ITEM NUMBER	DESIGN	PKG	WEIGHT
1.004.402	G1058305	V-terminal clamp size 1,2,3, 95-240 mm ² single solid, 70-240 mm ² single stranded, 50-185 mm ² round stranded, 70-240 mm ² round solid, M = 23 -27 Nm 1 set = 4 pieces	1 set	0.3 kg
1.004.403	H1058306	V-terminal clamp size 1,2,3, 95-300 mm ² single solid, 70-240 mm ² single stranded, 50-185 mm ² round stranded, 70-240 mm ² round solid, M = 23 -27 Nm 1 set = 4 pieces	1 set	0.3 kg

NH VERTICAL FUSE SWITCH DISCONNECTOR

MULTIVERT® 800A, 1260A

PRODUCT RANGE

Double Fuse Switch Disconnecter Size 2 and 3



1.400.000

MULTIVERT® NH-double vertical fuse switch disconnecter 800 A single pole switching for NH-fuse links size 2

CAT. NUMBER	ITEM NUMBER	CABLE TERMINATION COMPONENTS	PKG	WEIGHT
1.400.000	W1023266	triple cable termination M12 bolt	1 piece	11.6 kg
1.400.004	X1023267	quadruple cable termination M12 bolt	1 piece	12.12 kg

MULTIVERT® NH-double vertical fuse switch disconnecter 1260 A single pole switching for NH-fuse links size 3

CAT. NUMBER	ITEM NUMBER	CABLE TERMINATION COMPONENTS	PKG	WEIGHT
1.500.000	S1023125	triple cable termination M12 bolt	1 piece	13.3 kg
1.500.004	T1023126	quadruple cable termination M12 bolt	1 piece	13.8 kg



1.450.000

MULTIVERT® NH-double vertical fuse switch disconnecter 800 A triple pole switching for NH-fuse links size 2

CAT. NUMBER	ITEM NUMBER	CABLE TERMINATION COMPONENTS	PKG	WEIGHT
1.450.000	Y1023268	triple cable termination M12 bolt	1 piece	11.9 kg
1.450.004	Z1023269	quadruple cable termination M12 bolt	1 piece	12.3 kg

MULTIVERT® NH-double vertical fuse switch disconnecter 1260 A triple pole switching for NH-fuse links size 3

CAT. NUMBER	ITEM NUMBER	CABLE TERMINATION COMPONENTS	PKG	WEIGHT
1.550.000	V1023127	triple cable termination M12 bolt	1 piece	13.3 kg
1.550.004	W1023128	quadruple cable termination M12 bolt	1 piece	13.8 kg

NH VERTICAL FUSE SWITCH DISCONNECTOR

MULTIVERT® 1260A, 1600A

PRODUCT RANGE

Double Switch Disconnecter Size 2 and 3



1.400.000

MULTIVERT® NH-double vertical switch disconnecter 1260 A single pole switching
1260 A - application of NH-solid links size 2, 630 A, Art.Nr. 22SZSM1
800 A - application of NH-solid links size 2, 400 A

CAT. NUMBER	ITEM NUMBER	CABLE TERMINATION COMPONENTS	PKG	WEIGHT
1.400.000	W1023266	triple cable termination M12 bolt	1 piece	11.6 kg
1.400.004	X1023267	quadruple cable termination M12 bolt	1 piece	12.12 kg

MULTIVERT® NH-double vertical switch disconnecter 1600 A single pole switching
1600 A - application of NH-solid links size 3, 1000 A, Art.Nr. 33SZSM2
1260 A - application of NH-solid links size 3, 630 A

CAT. NUMBER	ITEM NUMBER	CABLE TERMINATION COMPONENTS	PKG	WEIGHT
1.500.000	S1023125	triple cable termination M12 bolt	1 piece	13.3 kg
1.500.004	T1023126	quadruple cable termination M12 bolt	1 piece	13.8 kg

NH VERTICAL FUSE SWITCH DISCONNECTOR

MULTIVERT® 1260A, 1600A

PRODUCT RANGE

Double Switch Disconnecter Size 2 and 3



1.450.000

MULTIVERT® NH-double vertical switch disconnecter 1260 A triple pole switching
1260 A - application of NH-solid links size 2, 630 A, Art.Nr. 22SZSM1
800 A - application of NH-solid links size 2, 400 A

CAT. NUMBER	ITEM NUMBER	CABLE TERMINATION COMPONENTS	PKG	WEIGHT
1.450.000	Y1023268	triple cable termination M12 bolt	1 piece	11.9 kg
1.450.004	Z1023269	quadruple cable termination M12 bolt	1 piece	12.3 kg

MULTIVERT® NH-double vertical switch disconnecter 1600 A triple pole switching
1600 A - application of NH-solid links size 3, 1000 A, Art.Nr. 33SZSM2
1260 A - application of NH-solid links size 3, 630 A

CAT. NUMBER	ITEM NUMBER	CABLE TERMINATION COMPONENTS	PKG	WEIGHT
1.550.000	V1023127	triple cable termination M12 bolt	1 piece	13.3 kg
1.550.004	W1023128	quadruple cable termination M12 bolt	1 piece	13.8 kg

ACCESSORIES

Cover/shrouds for cable termination



1.002.394

CAT. NUMBER	ITEM NUMBER	DESIGN	APPLICATION	PKG	WEIGHT
1.002.394	Z1023407	cover shroud for double vertical switch, width 200 mm, length 224 mm	bottom terminal	1 piece	0.45 kg
1.003.320	M1023304	cover shroud for double vertical switch, width 200 mm, length 278 mm	top terminal	1 piece	0.31 kg



1.003.320

NH VERTICAL FUSE SWITCH DISCONNECTOR

MULTIVERT® 1000A

Main Incomer, 690VAC

PRODUCT RANGE



1.762.900

MULTIVERT® main incomer 1000 A 1 x triple pole switching

CAT. NUMBER	ITEM NUMBER	CABLE TERMINATION COMPONENTS	DESIGN	PKG	WEIGHT
1.762.900	P1023122	M12 multiple termination Al/Cu max. 300 mm ² round stranded, sectoral stranded (2 cable lugs), Cu max. 150 mm ² round stranded, sectoral stranded (3 cable lugs), M = 32-38 Nm	with ready fitted NH-solid links 1000 A	1 piece	11.8 kg



1.712.900

MULTIVERT® main incomer 1000 A 3 x single pole switching

CAT. NUMBER	ITEM NUMBER	CABLE TERMINATION COMPONENTS	DESIGN	PKG	WEIGHT
1.712.900	N1023121	M12 multiple termination Al/Cu max. 300 mm ² round stranded, sectoral stranded (2 cable lugs), Cu max. 150 mm ² round stranded, sectoral stranded (3 cable lugs), M = 32-38 Nm	with ready fitted NH-solid links 1000 A	1 piece	11.5 kg

MULTIVERT® 630kVA/910A

Transformer Main Incomers, 690VAC

PRODUCT RANGE



MV6M301K701G

MULTIVERT® transformer main incomer 630 kVA / 910 A 1 x triple pole switching

CAT. NUMBER	ITEM NUMBER	CABLE TERMINATION COMPONENTS	DESIGN	PKG	WEIGHT
MV6M301K701G	V1023265	M12 multiple termination Al/Cu max. 300 mm ² round stranded, sectoral stranded (2 cable lugs), Cu max. 150 mm ² round stranded, sectoral stranded (3 cable lugs), M = 32-38 Nm	for NH-fuse links "gTr"	1 piece	14,7 kg

NH VERTICAL FUSE SWITCH DISCONNECTOR

MULTIVERT® 1250A

PRODUCT RANGE

Size 4a, 690VAC



1.000.093 1.000.094

MULTIVERT® 1250 A size 4a 3 x single pole switching

CAT. NUMBER	ITEM NUMBER	CABLE TERMINATION COMPONENTS	DESIGN	PKG	WEIGHT
1.000.093	A1023270	M16 screw terminal	bottom terminal	1 piece	16.4 kg
1.000.094	B1023271	M16 screw terminal	top terminal	1 piece	16.4 kg

MULTIVERT® 1600A

PRODUCT RANGE

Size 4a, 690VAC



1.000.095 1.000.096

MULTIVERT® 1600 A size 4a 3 x single pole switching

CAT. NUMBER	ITEM NUMBER	CABLE TERMINATION COMPONENTS	DESIGN	PKG	WEIGHT
1.000.095	C1023272	2xM12 screw terminal	bottom terminal	1 piece	16.5 kg
1.000.096	D1023273	2xM12 screw terminal	top terminal	1 piece	16.5 kg

BUS BAR SYSTEMS

MULTIFIX®

- Modern, flexible system with complete touch protection using covers, busbar support and adapters for 60 mm system
- System of triple pole fuse units:
 - D0, DII and DIII-fuse bases
 - D02-vertical fuse switch disconnectors, triple pole switching
 - Component adapters for D0-fuse switch disconnectors
 - NH-fuse switch disconnectors Multibloc® size 000, 00, 1 and 2
 - NH-vertical fuse switch disconnector Multivert® 160A, 1 x triple pole switching
- Various accessories: Power Supply devices supplied directly on busbars

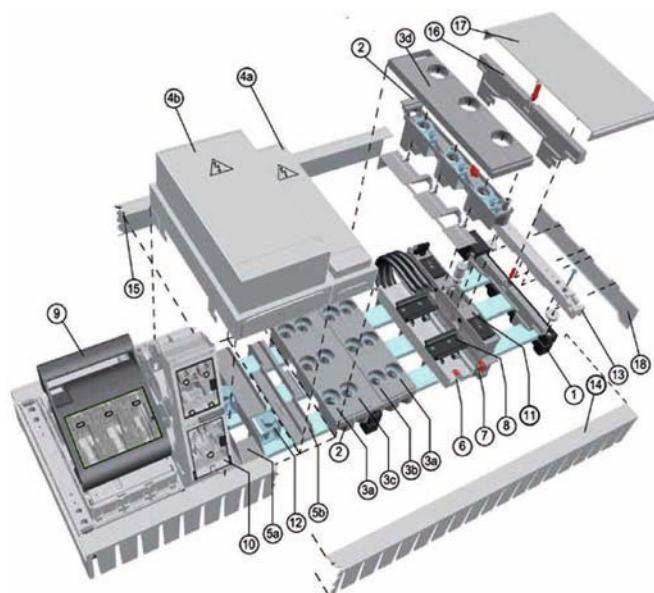

NR.	DESCRIPTION/PRODUCT	CATALOG NUMBER
1	Universal bus bar carrier for bus bars with width 5 and 10 mm 2 internal fixing holes two 25 mm self tapping fixing screws	1.002.100
2	Width 27mm, fingerproof, without cover	1.000.758
3a	Touch protection covers for D0-fuse bases triple pole width 27mm	1.000.762
3b	Touch protection covers for D0-fuse bases triple pole width 36mm, left side	1.000.763
3c	Touch protection covers for D0-fuse bases triple pole width 36mm, right side	1.000.767
4a	Touch protection cover caps grey 200 x 54 x 42mm, for clamps max. 1.5-35 mm ²	1.000.771
4b	Touch protection cover caps grey 200 x 108 x 78, 16–185 mm ²	1.000.773
5a	Bus bar p 1.000.774 protection plate width 108 mm	1.000.775
5b	Bus bar p 1.000.774 protection plate width 54 mm	1.000.774
6	Adapters 45 mm, 3 x 6 mm ²	1.000.787
7	Lateral extension piece, width 9mm	1.000.788
8	Universal supporting bars for component adapter, width 54 mm	1.000.791
9	Multibloc® 00.RST9 size 00	160 A 3.084.000
10	MULTIBLOC® 000.RST8 size 000 100 A, width 54mm	1.002.571
11	D02-vertical switch fuse disconnector 63A, 400VAC triple pole	1.002.602
12	Terminal clamps 16–185 mm ²	1.001.158
13	Compartmentalized conductor frame	1.001.075
14	Insulated covers with slots for supporting edge 32 mm	SAS0143
15	Insulated cover without slots for supporting edge 32 mm	SAS0142
16	Cover for spare area	SAS0148
17	Cover for spare area	SAS0149
18	Lateral cover for bus bar carrier attachable to 1.002.100 [1] in combination with 1.001.075 [13]	SA0145

BUS BAR SYSTEMS

MULTIFIX® 60

PRODUCT RANGE

Universal Bus Bar Carriers



1.002.100

Universal bus bar carriers triple pole

CATALOG NUMBER	ITEM NUMBER	DESIGN	PKG	WEIGHT
1.002.100	J1026452	universal bus bar carrier for bus bars with width 5 and 10 mm 2 internal fixing holes two 25 mm self tapping fixing screws	10	0.12 kg



1.002.101

Universal bus bar carriers single pole

CATALOG NUMBER	ITEM NUMBER	DESIGN	PKG	WEIGHT
1.002.101	K1026453	universal bus bar carrier for bus bars with width 5 and 10 mm attachable to art.no. 1.002.100 left and/or right for extension to 4- or 5-pole bus bar carrier one 25 mm self tapping fixing screw	10	50 g
1.002.102	L1026454	universal bus bar carrier for bus bars with width 5 and 10 mm for individual installation two 25 mm self tapping fixing screws	10	40 g



1.002.102



1.002.103

End cover for universal bus bar carrier triple pole

CATALOG NUMBER	ITEM NUMBER	DESIGN	PKG	WEIGHT
1.002.103	J1026498	touch protection single (1 x 90° angle) yellow with warning label	10	23.7 g
1.002.104	K1026499	touch protection with lateral cover (2 x 90° angle), yellow with warning label	10	54 g



1.002.104



1.002.105

End cover for universal bus bar carrier single pole

CATALOG NUMBER	ITEM NUMBER	DESIGN	PKG	WEIGHT
1.002.105	M1026501	touch protection single (1 x 90° angle) yellow with warning label	10	12 g
1.002.106	N1026502	touch protection with lateral cover (2 x 90° angle), yellow with warning label	10	7 g



1.002.106



1.002.109

External fixing device

CATALOG NUMBER	ITEM NUMBER	DESIGN	PKG	WEIGHT
1.002.109	R1026505	external additional fixing device for bus bar carrier triple pole art.no. 1.002.100 (with self tapping fixing screw 10mm)	20	6 g



1.002.107 1.002.108

Fixing screws

CATALOG NUMBER	ITEM NUMBER	DESIGN	PKG	WEIGHT
1.002.107	P1026503	self tapping fixing screw 25 mm	20	4 g
1.002.108	Q1026504	self tapping fixing screw 10 mm	20	2 g

BUS BAR SYSTEMS

MULTIFIX® 60

Universal Bus Bar Carriers

PRODUCT RANGE



1.002.110

Connection piece for bus bar carrier double pole

CATALOG NUMBER	ITEM NUMBER	DESIGN	PKG	WEIGHT
1.002.110	S1026506	connection piece for assembly of bus bar carrier double pole with two pieces bus bar carrier single pole art.no. 1.002.101	20	6 g

MULTIFIX® 60 Bus Bar Carriers

PRODUCT RANGE



1.000.752

Bus bar carriers triple pole

CATALOG NUMBER	ITEM NUMBER	DESIGN	PKG	WEIGHT
1.000.752	P1026480	bus bar carrier for individual installation 2 internal fixing holes + 2 external fixing holes	10	0.13 kg



1.000.755

Bus bar carriers double pole

CATALOG NUMBER	ITEM NUMBER	DESIGN	PKG	WEIGHT
1.000.755	Z1026443	bus bar carrier for individual installation 2 fixing holes	10	70 g



1.000.757

End cover for bus bar carrier triple pole

CATALOG NUMBER	ITEM NUMBER	DESIGN	PKG	WEIGHT
1.000.757	T1026461	touch protection single (1 x 90° angle) yellow with warning label for bus bar carrier art.no. 1.000.752	10	15 g

MULTIFIX® 60 D02 Vertical Fuse Bases E18

PRODUCT RANGE



1.000.758

DO-vertical fuse bases triple pole

CATALOG NUMBER	ITEM NUMBER	THREAD	DESIGN	PKG	SIZE	WEIGHT
1.000.758	G1026634	E18	width 27mm, fingerproof, without cover	10	D02	0.15 kg
1.000.759	H1026635	E18	width 27mm, fingerproof, with cover	10	D02	0.16 kg



1.000.759

BUS BAR SYSTEMS

MULTIFIX® 60 D02 Vertical Fuse Bases E18

PRODUCT RANGE



1.000.764

Touch protection covers for D0-fuse bases triple pole

CATALOG NUMBER	ITEM NUMBER	APPLICATION	DESIGN	PKG	WEIGHT
1.000.762	A1026444	-	width 27mm	10	10 g
1.000.763	B1026445	left side	width 36mm, with extension	10	20 g
1.000.764	C1026446	left side	width 54mm, with extension	10	30 g
1.000.765	D1026447	cover pair left and right	width 2 x 36mm, with extension	10	40 g
1.000.767	E1026448	right side	width 36mm, with extension	10	30 g
1.002.607	W1026624	cover pair top and bottom	cover pair for top and bottom of fuse base for rear touch protection of bus bar	10	20 g

DO-supplementary set

CATALOG NUMBER	DESIGN	WEIGHT KG ¹	PKG
1.001.582	complete supplementary set for distribution units: 1 D02-fuse base 1.000.758 1 touch protection cover 1.000.762 3 D02 screw caps 0801 2 terminal clamps 1.000.776	0.26	1

¹ weight in kg per piece or set including PKG

MULTIFIX® 60 D-Vertical Fuse Bases

PRODUCT RANGE



SAS01444

DII-vertical fuse base, E27 triple pole

CATALOG NUMBER	ITEM NUMBER	THREAD	DESIGN	WEIGHT KG ¹	PKG	SIZE	WEIGHT
SAS01918	S207430	E27	without cover width 42 mm, adapter ring system	0.19	10	DII	0.23 kg
SAS01444	J1031972	E27	with cover width 42 mm, adapter screw system	-	10	DII	0.28 kg

¹ weight in kg per piece or set including PKG

Covers for DII-vertical fuse base, E27 triple pole

CATALOG NUMBER	ITEM NUMBER	THREAD	DESIGN	WEIGHT KG ¹	PKG	SIZE	WEIGHT
SAS01923	B211486	E27	double cover, width 84mm	0.05	10	DII	83.4 g

¹ weight in kg per piece or set including PKG



SAS01443

DIII-vertical fuse base, E33 triple pole

CATALOG NUMBER	ITEM NUMBER	THREAD	DESIGN	WEIGHT KG ¹	PKG	SIZE	WEIGHT
SAS01919	B213579	E33	without cover width 42 mm, adapter ring system	0.26	10	DIII	0.32 kg
SAS01443	K1031973	E33	with cover width 57 mm, adapter screw system	-	10	DIII	0.37 kg

¹ weight in kg per piece or set including PKG

MULTIFIX® 60 D-Vertical Fuse Bases

PRODUCT RANGE

Covers for DIII-vertical fuse base, E33 triple pole

CATALOG NUMBER	ITEM NUMBER	THREAD	DESIGN	WEIGHT KG ¹	PKG	SIZE	WEIGHT
SAS01924	P215615	E33	single cover, width 42mm	0.04	10	DIII	61 g
SAS01925	G218644	E33	double cover, width 84mm	0.06	10	DIII	6 g

¹weight in kg per piece or set including PKG

MULTIFIX® 60

PRODUCT RANGE

Touch Protection Cover Caps, Terminal Clamp Plates

Touch protection cover caps yellow with warning label

CATALOG NUMBER	ITEM NUMBER	DESIGN	PKG	WEIGHT
1.000.768	F1046206	200 x 54 x 42mm, for clamps max. 1.5-35 mm ²	2	0.12 kg
1.000.769	G1046207	200 x 108 x 42mm, for clamps max.16-70 mm ²	2	0.15 kg
1.000.770	H1046208	200 x 108 x 78mm, for clamps max. 16-185 mm ²	2	0.21 kg

Touch protection cover caps grey

CATALOG NUMBER	ITEM NUMBER	DESIGN	PKG	WEIGHT
1.000.771	L1026431	200 x 54 x 42mm, for clamps max. 1.5-35 mm ²	10	16 g
1.000.772	M1026432	200 x 108 x 42mm, for clamps 16-70 mm ²	10	0.15 kg
1.000.773	N1026433	200 x 108 x 78mm, for clamps 16-185 mm ²	10	0.21 kg



1.000.771



1.000.772



1.000.773



1.000.774



1.000.775

Bus bar protection plates

CATALOG NUMBER	ITEM NUMBER	DESIGN	PKG	WEIGHT
1.000.774	P1026434	bus bar protection plate width 54 mm	10	8 g
1.000.775	N1026479	bus bar protection plate width 108 mm	10	20 g

BUS BAR SYSTEMS

MULTIFIX® 60

PRODUCT RANGE

Touch Protection Cover Caps, Terminal Clamp Plates



SAS01414

Terminal clamp plates, 84 x 59 x 200 mm triple pole

CATALOG NUMBER	ITEM NUMBER	DESIGN	THICKNESS OF BUS BAR	PKG	WEIGHT
SAS01412	E212041	terminal clamp plate complete, 200 x 84 x 59 mm for bus bars with thickness 5 mm, 35-120 mm²	5 mm	1	0.43 kg
SAS01414	Z211530	terminal clamp plate complete, 200 x 84 x 59 mm for bus bars with thickness 10 mm, 35-120 mm²	10 mm	1	0.45 kg
SAS01413	H218691	cover for terminal clamp plate 5/10mm	-	10	0.13 kg



1.000.776 1.000.777



1.000.778 1.000.779



1.000.780

Universal terminal clamps for bus bars with a thickness of 5 mm

CATALOG NUMBER	ITEM NUMBER	DESIGN	THICKNESS OF BUS BAR	Ø MAX.	MAX. TIGHTENING TORQUE	TERMINAL	A	B	C	PKG	WEIGHT
1.000.776	K200730	-	5 mm	75 mm	3 Nm	1.5 ... 16 mm²	25.5 mm	11.5 mm	27 mm	10	23.7 g
1.000.777	V1026462	round terminal 70-300 mm² round solid	5 mm	11 mm	6 Nm	1.5 ... 35 mm²	26.5 mm	16 mm	31.5 mm	20	50 g
1.000.778	W1026463	flat terminal 11 x 21 x 1 (x 2) round solid	5 mm	11 mm	6 Nm	1.5 ... 60 mm²	26.5 mm	16 mm	35 mm	20	60 g
1.000.779	J201787	-	5 mm	14 mm	10 Nm	16 ... 70 mm²	28 mm	20.5 mm	39 mm	10	67 g
1.000.780	V207524	-	5 mm	17 mm	10 Nm	16 ... 120 mm²	29 mm	23.5 mm	46 mm	10	93 g
1.001.157	G1026450	width 45 mm, Doppelterminal withtig, 2 mal 3 x 4 mm²	5 mm	22 mm	10 Nm	16 ... 185 mm²	29 mm	28.5 mm	49 mm	3	0.18 kg



1.000.781 1.000.782



1.000.783 1.000.784



1.000.785

Universal terminal clamps for bus bars with a thickness of 10 mm

CATALOG NUMBER	ITEM NUMBER	DESIGN	THICKNESS OF BUS BAR	Ø MAX.	MAX. TIGHTENING TORQUE	TERMINAL	A	B	C	PKG	WEIGHT
1.000.781	W219209	-	10 mm	75 mm	3 Nm	1.5 ... 16 mm²	25.5 mm	11.5 mm	31.5 mm	10	23 g
1.000.782	A1026490	width 45 mm, central double terminal, 2 x 3 x 6 mm²	10 mm	11 mm	6 Nm	1.5 ... 35 mm²	28.5 mm	16 mm	36.5 mm	20	50 g
1.000.783	B1026491	width 45 mm, terminal 3 x 4 mm²	10 mm	11 mm	6 Nm	1.5 ... 60 mm²	26.5 mm	16 mm	10 mm	20	60 g
1.000.784	F222185	-	10 mm	14 mm	10 Nm	16 ... 70 mm²	28 mm	20.5 mm	45.5 mm	10	71.6 g
1.000.785	B222940	-	10 mm	17 mm	10 Nm	16 ... 120 mm²	29 mm	23.2 mm	51 mm	10	95.8 g
1.001.158	H1026451	width 45 mm, terminal 3 x 6 mm²	10 mm	22 mm	10 Nm	16 ... 185 mm²	29 mm	28.5 mm	53 mm	3	0.18 kg

BUS BAR SYSTEMS

MULTIFIX® 60 Terminal Clamp Module

PRODUCT RANGE



1.001.047

Terminal clamp module 630 A triple pole

CATALOG NUMBER	ITEM NUMBER	DESIGN	PKG	WEIGHT
1.001.047	V1026416	width 45 mm, terminal 3 x 10 mm ²	1	0.25 kg
1.001.853	K1026430	width 45 mm, terminal 3 x 16 mm ²	1	1.5 kg

MULTIFIX® 60 Component Adapters

PRODUCT RANGE



1.001.163

Component adapter double central terminal

CATALOG NUMBER	ITEM NUMBER	DESIGN	PKG	NOMINAL CURRENT	WEIGHT
1.001.074	X1026441	width 45 mm, without contacts, extendable	4	25 A	0.25 kg
1.001.163	Y1026442	triple pole switching	4	35 A	0.28 kg

Component adapters for top terminal

CATALOG NUMBER	ITEM NUMBER	DESIGN	PKG	NOMINAL CURRENT	WEIGHT
1.001.072	S1026437	triple pole switching with neutral conductor	4	25 A	0.19 kg
1.000.786	Q1026435	triple pole switching with auxiliary switch	4	35 A	0.2 kg
1.001.073	V1026439	triple pole switching with neutral conductor and auxiliary switch	4	63 A	0.23 kg
1.000.787	R1026436	triple pole switching	4	80 A	0.26 kg



1.000.789

Component adapters without contacts

CATALOG NUMBER	ITEM NUMBER	DESIGN	PKG	NOMINAL CURRENT	WEIGHT
1.000.789	M1026478	distance piece height 5 mm for re-installation on to bus bars with a thickness of 5 mm after dismantling of installation on to 10 mm bus bars	4	35 A	0.15 kg

Universal supporting bars for component adapter



1.000.790 1.000.791



1.000.792 1.000.793



1.000.794

CATALOG NUMBER	ITEM NUMBER	DESIGN	PKG	WEIGHT
1.000.790	D1026493	width 45 mm	10	10.7 g
1.000.791	E1026494	width 54 mm	10	20.2 g
1.000.792	F1026495	width 63 mm	10	21.2 g
1.000.793	G1026496	width 72 mm	10	23 g
1.000.794	H1026497	width 81 mm	10	24.4 g

MULTIFIX® 60

PRODUCT RANGE

D02 Vertical Switch Fuse Disconnecter 63 A, 400 V AC Triple Pole

D02-vertical switch fuse disconnecter 63A, 400VAC triple pole



1.002.602

CATALOG NUMBER	ITEM NUMBER	POLES	DESIGN	PKG	SIZE	WEIGHT
1.002.602	M1006399	3	triple pole switching	3	D02	0.35 kg
1.002.603	P1006401	3	triple pole switching with neutral conductor	3	D02	0.44 kg
1.002.604	R1026620	3	triple pole switching with auxiliary switch	3	D02	0.35 kg
1.002.605	S1026621	3	triple pole switching with neutral conductor and auxiliary switch	3	D02	0.44 kg



1.002.606

Adapter clip for D01-fuse links 2 - 16A

CATALOG NUMBER	ITEM NUMBER	DESIGN	WEIGHT KG ¹	PKG	WEIGHT
1.002.606	Q1006402	adapter ring for D01 fuse links 2 A - 16 A	0.03	12	2.6 g

¹weight in kg per piece or set including PKG



1.003.160

Extra fuse plug for D0-fuse links

CATALOG NUMBER	ITEM NUMBER	DESIGN	WEIGHT KG ¹	PKG	WEIGHT
1.003.160	L1026615	external fuse plug 63 A, 400 V AC for TYTAN® R, 1 set = 3 pieces	0.06	30	18 g

¹weight in kg per piece or set including PKG

MULTIFIX® 60

PRODUCT RANGE

D02 Vertical Fuse Switch Disconnecter 63A, 400VAC, Triple Pole Switching

D02-vertical fuse switch disconnecter 63 A, 400 VAC triple pole



1.001.040

CATALOG NUMBER	ITEM NUMBER	POLES	DESIGN	PKG	WEIGHT
1.001.040	V1026600	3	triple pole switching	1 piece	0.26 kg



1.001.039

Level adjustment to re-equip switch for installation on to bus bars with thickness of 5mm (after having been installed on to bus bars with a thickness of 10mm)

CATALOG NUMBER	ITEM NUMBER	DESIGN	PKG	WEIGHT
1.001.039	T1026599	distance piece height 5 mm for re-installation on to bus bars with a thickness of 5 mm after dismantling of installation on to 10 mm bus bars	100	2 g

MULTIFIX® 60

PRODUCT RANGE

MULTIBLOC® NH Fuse Switch Disconnecter



1.002.571

MULTIBLOC® 000.RST8 size 000 100 A, 690VAC bus bar installation, triple pole

CATALOG NUMBER	ITEM NUMBER	POLES	CABLE TERMINATION COMPONENTS	PKG	WEIGHT
1.002.571	L1002166	3	3 frame clamps 2,5-50 mm² bottom terminal	1 piece	0.6 kg
1.002.572	L1023050	3	3 frame clamps 2,5-50 mm² top terminal	1 piece	0.62 kg



3.084.000

MULTIBLOC® 00.RST9 size 00 160A, bus bar installation 60mm, triple pole

CATALOG NUMBER	ITEM NUMBER	POLES	BUS BAR INSTALLATION	CABLE TERMINATION COMPONENTS	DESIGN	PKG	WEIGHT
3.084.000	Z1022993	3	60 mm snap on	3 M8 terminal screws 3 clamp straps 4–70 mm²	-	1 piece	0.93 kg
3.083.000	X1022991	3	60 mm snap on	3 frame clamps Cu 2,5-70 mm² factory assembled	-	1 piece	0.88 kg
3.084.300	D1022997	3	60 mm snap on	3 M8 terminal screws 3 clamp straps 4–70 mm²	fixed window to protect against unauthorized connection	1 piece	0.88 kg
3.083.300	Y1022992	3	60 mm snap on	3 frame clamps Cu 2,5-70 mm² factory assembled	fixed window to protect against unauthorized connection	1 piece	0.88 kg
3.084.100	B1022995	3	60 mm snap on	3 M8 terminal screws 3 clamp straps 4–70 mm²	with electronic fuse monitoring ESÜ installed (rated voltage = 525VAC)	1 piece	0.96 kg
3.084.200	C1022996	3	60 mm snap on	3 M8 terminal screws 3 clamp straps 4–70 mm²	with electro-mechanic fuse monitoring MZS installed (galvanic isolation)	1 piece	1.46 kg



3.084.100



3.084.200



1.000.323

MULTIBLOC® 1.RST8 size 1 250A, 690VAC bus bar installation, triple pole

CATALOG NUMBER	ITEM NUMBER	POLES	CABLE TERMINATION COMPONENTS	DESIGN	PKG	WEIGHT
1.000.323	T229879	3	3 M10 terminal screws	-	1 piece	3.09 kg
1.001.294	O1023054	3	3 clamp straps 70–150 mm²	-	1 piece	3.06 kg
1.003.134	R1023055	3	3 M10 terminal screws	with electronic fuse monitoring ESÜ installed (rated voltage = 525VAC)	1 piece	3.14 kg
1.000.855	M1023051	3	3 M10 terminal screws	with electro-mechanic fuse monitoring MZS installed (galvanic isolation)	1 piece	3.8 kg
1.000.936	P1023053	3	6 M10 terminal screws	main incomer	1 piece	4.68 kg



1.000.855

MULTIFIX® 60

PRODUCT RANGE

MULTIBLOC® NH Fuse Switch Disconnecter



1.003.135

MULTIBLOC® 2.RST8 size 2 400A, 690VAC bus bar installation, triple pole

CATALOG NUMBER	ITEM NUMBER	POLES	CABLE TERMINATION COMPONENTS	DESIGN	PKG	WEIGHT
1.000.704	M1002167	3	3 M10 terminal screws	-	1 piece	4.77 kg
1.001.295	C1023065	3	3 clamp straps 120–240 mm²	-	1 piece	4.61 kg
1.003.135	D1023066	3	3 M10 terminal screws	with electronic fuse monitoring ESÜ installed (rated voltage = 525VAC)	1 piece	4.6 kg
1.000.856	Z1023062	3	3 M10 terminal screws	with electro-mechanic fuse monitoring MZS installed (galvanic isolation)	1 piece	5.28 kg
1.001.028	A1023063	3	6 M10 terminal screws	main incomer	1 piece	5.74 kg

ACCESSORIES



1.000.126

1.003.431



1.002.874



1.000.127



1.000.128

Cover shields

CATALOG NUMBER	ITEM NUMBER	DESIGN	PKG	WEIGHT
1.000.126	Y229285	cover shield for installation in distribution units size (width x height): 123 x 190 mm for one 00.ST9/00.RST9	1 piece	22 g
1.003.431	N1022960	cover shield for installation in distribution units size (width x height): 123 x 210 mm for one 00.ST9/00.RST9	1 piece	30 g
1.002.874	S1022964	cover shield for installation in distribution units size (width x height): 231 x 210 mm for two 00.ST9/00.RST9	1 piece	57 g
1.000.127	Z229286	cover shield for installation in distribution units size (width x height): 231 x 190 mm for two 00.ST9/00.RST9	1 piece	46 g
1.000.128	A229287	cover shield for installation in distribution units size (width x height): 339 x 190 mm for three 00.ST9/00.RST9	1 piece	30 g
1.000.353	Z229884	cover shield for installation in distribution units size (width x height): 210 x 260 mm for one 1.ST8/1.RST8 triple pole	1 piece	68 g
1.002.351	X1022968	cover shield for installation in distribution units size (width x height): 230 x 283 mm for one 1.ST8/1.RST8 triple pole	1 piece	90 g
1.000.863	V1002174	cover shield for installation in distribution units size (width x height): 230 x 300 mm for one 2.ST8/2.RST8 triple pole	1 piece	0.10 kg
1.002.352	Y1022969	cover shield for installation in distribution units size (width x height): 234 x 310 mm for one 2.ST8/2.RST8 triple pole	1 piece	0.11 kg
1.002.870	R1022963	cover shield for installation in distribution units size (width x height) 231 x 210 mm for one 00.ST9/00.RST9 + lateral spare way cover right side	1 piece	95 g

MULTIFIX® 60

MULTIBLOC® NH Fuse Switch Disconnecter

ACCESSORIES



1.002.644



1.003.347



1.002.643



1.000.852



1.000.157



1.000.155



1.000.150

Cover/shrouds for cable termination

CATALOG NUMBER	ITEM NUMBER	DESIGN	PKG	WEIGHT
1.000.148	W229283	cover for cable terminal connection for 00.ST9 triple pole, 1 set = 2 pieces	1 set	43 g
1.000.382	V229880	cover for cable terminal connection for 1.ST8 triple pole, 1 set = 2 pieces	1 set	0.29 kg
1.000.861	N1002168	cover for cable terminal connection for 2.ST8 triple pole, 1 set = 2 pieces	1 set	0.31 kg
1.002.644	N1022983	cover for cable terminal connection, 1 set = 2 pieces	1 set	68 g
1.003.325	F1023114	bus bar touch protection for 00.RST9	1 piece	25 g
1.003.347	H1023116	bus bar touch protection for 2.RST8	1 piece	97 g
1.003.329	G1023115	bus bar touch protection for 1.RST8	1 piece	82 g

Indication facilities

CATALOG NUMBER	ITEM NUMBER	DESIGN	PKG	WEIGHT
1.002.643	T1022988	indicator for switch door position micro switch 1 change-over contact 5 A, 250 V for MULTIBLOC® 000.RST8 1 set = 3 pieces	1 piece	0.1 kg
1.000.852	Q1002285	indicator for switch door position micro switch, 1 change-over contact 5 A, 250 V	1 piece	90 g
1.000.157	S1022987	indicator for switch door position micro switch 1 "a" contact/ 1 "b" contact, 5 A, 250 V for MULTIBLOC® 00.RST9 for 40 mm bus bar system	1 piece	0.1 kg

Locking and sealing devices/cover sealing device

CATALOG NUMBER	ITEM NUMBER	DESIGN	PKG	WEIGHT
1.000.155	L229297	cover sealing device-installation set for 00.ST8 1-, 2-, 4-pole and 1.ST8/RST8	1 piece	10 g

Locking and sealing devices/locking device for window

CATALOG NUMBER	ITEM NUMBER	DESIGN	PKG	WEIGHT
1.000.150	K229296	locking device for window for 00.ST8 1-, 2-, 4-pole and 1./2.ST8/RST8 1 set = 3 pieces	1 set	20 g

MULTIFIX® 60

MULTIBLOC® NH Fuse Switch Disconnecter

ACCESSORIES

Varieties of cable termination



CATALOG NUMBER	ITEM NUMBER	DESIGN	PKG	WEIGHT
OOSZS	M229298	M8 terminal screw for switch gear size 00 1 set = 3 pieces	1 set	35 g
OOSZESK	E214594	clamp strap Cu 4–70 mm ² for switch gear size 00 1 set = 3 pieces	1 set	35 g
OOSZA70	R211523	Al/Cu clamp 1,5–70 mm ² for switch gear size 00 1 set = 3 pieces	1 set	75 g
1.003.571	V1033684	Al/Cu clamp 50–95 mm ² round stranded for switch gear size 00 1 set = 3 pieces	1 set	88 g
1.003.433	L1022958	triple clamp per pole 1.5 up to 16 mm ² 1 set = 3 pieces	1 set	0.14 kg
OOSZSV6	K1022957	V-shaped lug size 00, M8, for V-terminal clamp size 00 for switch gear size 00 with screw terminal supplementary set for V-terminal with V-terminal clamps 1 set = 3 pieces	1 set	0.13 kg
1.000.420	E229889	clamp strap 70–150 mm ² pour 1.ST8 1- 4-pôle + 1.RST8, 1 set = 3 pièces	1 set	0.14 kg
1.001.830	J1023117	V-shaped lug size 1, M8, for V-terminal clamp size 1 for 1.ST8 1- to 4-pole + 1.RST8, supplementary set for V-terminal with use of V-clamps 1 set = 3 pieces	1 set	90 g
1.001.237	B1002180	clamp strap size 2 120–240 mm ² , 1 set = 3 pieces	1 set	0.26 kg
13SZAV6	K1023118	V-terminal size 1,2,3; M12, for V-terminal clamps size 1,2,3 for MULTIBLOC® size 2 supplementary set for V-terminal with use of V-clamps 1 set = 3 pieces	1 set	0.27 kg
13SZAD6	A1022971	M12 terminal lugs for M12 double terminal for MULTIBLOC® size 2 and 3 1 set = 3 pieces	1 set	0.26 kg

MULTIFIX® 60

MULTIVERT® Vertical NH Fuse Switch Disconnecter

PRODUCT RANGE

MULTIVERT® 160 A size 00 60 mm bus bar system 1 x triple pole switching



1.000.909

CATALOG NUMBER	ITEM NUMBER	CABLE TERMINATION COMPONENTS	DESIGN	PKG	WEIGHT
1.000.909	E1002183	3 M8 terminal screws/3 clamp straps 4-70 mm ²	bottom terminal with cover shroud MZ00KH	1 piece	1.45 kg
1.002.489	Z1023154	3 frame clamps Cu 2,5-70 mm ²	bottom terminal with cover shroud MZ00KH	1 piece	1.3 kg
1.003.140	A1023155	3 M8 terminal screws/3 clamp straps 4-70 mm ²	bottom terminal MULTIVERT® 1.000.909 with cabling of instrument leads	1 piece	1.5 kg
1.003.307	C1023157	3 M8 terminal screws/3 clamp straps 4-70 mm ²	top terminal with cover shroud MZ00KH	1 piece	1.5 kg
1.003.308	D1023158	3 M8 terminal screws/3 clamp straps 4-70 mm ²	top terminal MULTIVERT® 1.003.307 with cabling of instrument leads	1 piece	1.5 kg
1.003.309	E1023159	3 frame clamps Cu 2,5-70 mm ²	top terminal with cover shroud MZ00KH	1 piece	1.3 kg

MULTIFIX® 60

MULTIVERT® Vertical NH Fuse Switch Disconnecter

ACCESSORIES



MZ00KH



MZ00KA

Cover/shrouds for cable termination

CATALOG NUMBER	ITEM NUMBER	DESIGN	PKG	WEIGHT
MZ00KH	F1023298	cover shroud length 106 mm for MULTIVERT®/BSL 160 A	1 piece	20 g
MZ00KA	L1023464	extended cover shroud for cover shroud MZ00KH	1 piece	40 g
1.000.915	H1023300	cover shroud for MULTIVERT®/BSL 160 A with V-terminal	1 piece	50 g



MZAW

Covers/level & system adjustment covers

CATALOG NUMBER	ITEM NUMBER	DESIGN	PKG	WEIGHT
MZ00AAD	X214081	2 piece adjustment, with integrated area for labeling to adapt to MULTIVERT® for 185 mm bus bar system	1 set	0.1 kg
MZAW	D218687	support angle for support of cover plate 1 set = 4 pieces	1 set	27 g



1.002.939

Indication facilities

CATALOG NUMBER	ITEM NUMBER	DESIGN	PKG	WEIGHT
1.002.939	Y1023452	electronic fuse monitoring ESÜ size 00 for MULTIVERT® 160 A with cabling of instrument leads (rated voltage 525VAC)	1 piece	0.66 kg
1.000.852	Q1002285	indicator for switch door position micro switch, 1 change-over contact 5 A, 250 V	1 piece	90 g



1.000.852



1.000.107



1.000.101

Amperemeter units

CATALOG NUMBER	ITEM NUMBER	DESIGN	PKG	WEIGHT
1.000.106	R1023285	size 00, 100 A, with drag indicator, triple pole measurement (optional L1, L2, L3)	1 piece	0.34 kg
1.000.107	S1023286	size 00, 150 A, with drag indicator, triple pole measurement (optional L1, L2, L3)	1 piece	0.34 kg
1.000.100	K1023279	size 00, 100 A, with drag indicator, single pole measurement	1 piece	0.34 kg
1.000.101	L1023280	size 00, 150 A, with drag indicator, single pole measurement	1 piece	0.34 kg



MZ00BT2

Labelling facilities

CATALOG NUMBER	ITEM NUMBER	DESIGN	PKG	WEIGHT
MZ00BT2	K215611	label holder size 00	1 piece	10 g

MULTIFIX® 60

MULTIVERT® Vertical NH Fuse Switch Disconnecter

ACCESSORIES

Varieties of cable termination



OOSZS

OOSZESK



1.003.433



OOSZVK1



1.000.098

CATALOG NUMBER	ITEM NUMBER	DESIGN	PKG	WEIGHT
OOSZS	M229298	M8 terminal screw for switch gear size 00 1 set = 3 pieces	1 set	35 g
OOSZESK	E214594	clamp strap Cu 4–70 mm ² for switch gear size 00 1 set = 3 pieces	1 set	35 g
OOSZA70	R211523	Al/Cu clamp 1,5–70 mm ² for switch gear size 00 1 set = 3 pieces	1 set	75 g
1.003.571	V1033684	Al/Cu clamp 50–95 mm ² round stranded for switch gear size 00 1 set = 3 pieces	1 set	88 g
1.003.433	L1022958	triple clamp per pole 1.5 up to 16 mm ² 1 set = 3 pieces	1 set	0.14 kg
OOSZVK1	D1023434	V-terminal clamp taille 00, 10–70 mm ² round stranded, 10–95 mm ² round solid, 35–95 mm ² simple stranded, 50–95 mm ² simple solid, M = 12 Nm	30	0.4 kg
1.000.098	E1023435	insulation cap for V-terminal clamp size 00	12/120	2 g

MULTIFIX® 60 Plate Clamps

PRODUCT RANGE



SAS01205 SAS01206



SAS01996 SAS01997

Plate clamps

CATALOG NUMBER	ITEM NUMBER	DESIGN	PKG	WEIGHT
SAS01205	M1026455	for bus bars with width 12 mm, inner width of clamp 25 mm	10	10 g
SAS01206	N1026456	for bus bars with width 20 mm, inner width of clamp 40 mm	10	0.21 kg
SAS01586	P1026457	for bus bars with width 30 mm, inner width of clamp 30 mm	10	0.2 kg
SAS01587	Q1026458	for bus bars with width 30 mm, inner width of clamp 35 mm	10	0.21 kg
SAS01996	R1026459	for bus bars with width 20 mm, inner width of clamp 25 mm	10	0.19 kg
SAS01997	Z1026489	for bus bars with width 20 mm, inner width of clamp 30 mm	10	0.16 kg

MULTIFIX® 60

Covering and Compartmentalizing Material

Compartmentalized conductor frame



1.001.075

CATALOG NUMBER	ITEM NUMBER	DESIGN	PKG	WEIGHT
1.001.075	F1026449	compatible to bus bar carrier 1.000.752 for supporting edge 32 mm [distance washer included]	10	60 g

BUS BAR SYSTEMS

MULTIFIX® 60

Covering and Compartmentalizing Material

PRODUCT RANGE

Insulated covers



SAS0142



SAS0143

CATALOG NUMBER	ITEM NUMBER	DESIGN	PKG	WEIGHT
SAS0142	D222896	insulated cover without slots for supporting edge 32 mm	5 pieces à 2 meter	0.52 kg
SAS0143	T215573	insulated cover with slots for supporting edge 32 mm	5 pieces à 2 meter	0.52 kg
SAS0145	W218128	lateral cover for bus bar carrier attachable to art.no. 1.001.075	10	40 g

Cover for spare area



SAS0148

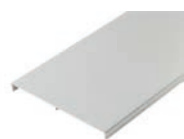

SAS0149

CATALOG NUMBER	ITEM NUMBER	DESIGN	THICKNESS OF BUS BAR	WIDTH OF BUS BAR	PKG	WEIGHT
SAS0148	D211488	blanking support system for supporting edge 32 mm	-	-	10 pieces à 1 meter	50 g
SAS0149	F214043	cover for spare area	5 mm	12 ... 30 mm	3	0.80 kg

Bus bar covers



1.000.932

CATALOG NUMBER	ITEM NUMBER	DESIGN	THICKNESS OF BUS BAR	WIDTH OF BUS BAR	PKG	WEIGHT
1.000.931	V218173	Cover profile for a single busbar with a thickness of 5mm	5 mm	12 ... 30 mm	10 pieces of 1 meter	90 g
1.000.932	X216128	Cover profile for a single busbar with a thickness of 10mm	10 mm	12 ... 30 mm	10 pieces of 1 meter	0.1 kg

MULTIFIX® 60 System cover

PRODUCT RANGE

D02-cover shielding set for MULTIFIX® 60 for supporting edge 70 mm



1.001.729

CATALOG NUMBER	ITEM NUMBER	DESIGN	PKG	WEIGHT
1.001.729	K1026614	cover shield for D02-fuse base for total length of 325 mm 1 set=2 lateral shields+2 coverf shields (snap on)	1 set	0.16 kg
1.001.386	H1026612	end shielding for total length 350mm	1 set	0.11 kg
1.001.387	J1026613	end shielding for total length 255mm	1 set	0.13 kg
1.001.204	A1026421	cover shield for MULTIBLOC® size 00, for total length 350mm, 1 set = top cover shield + bottom cover shield	1 set	80 g
1.001.390	J1026429	cover shield for MULTIBLOC® size 00, for total length 255mm, 1 set = top cover shield + bottom cover shield	1 set	70 g

MULTIFIX® 60 System cover

PRODUCT RANGE



1.001.203

Cover shields for MULTIBLOC® and MULTIVERT® for supporting edge 70 mm

CATALOG NUMBER	ITEM NUMBER	DESIGN	PKG	WEIGHT
1.001.200	W1026417	cover shield for MULTIBLOC® size 00, for total length 350mm, 1 set = top cover shield + bottom cover shield	1 set	70 g
1.001.388	G1026427	cover shield for MULTIBLOC® size 00, for total length 255mm, 1 set = top cover shield + bottom cover shield	1 set	40 g
1.001.201	X1026418	cover shield for MULTIBLOC® size 1, for total length 350mm, 1 set = top cover shield + bottom cover shield	1 set	0.11 kg
1.001.389	H1026428	cover shield for MULTIBLOC® size 1, for total length 255mm, 1 set = top cover shield + bottom cover shield	1 set	50 g
1.001.202	Y1026419	cover shield for MULTIBLOC® size 2, for total length 350mm, 1 set = top cover shield + bottom cover shield	1 set	0.12 kg
1.001.203	Z1026420	cover shield for MULTIVERT® 160 A triple pole switching, for total length 350 mm, 1 set = top cover shield + bottom cover shield	1 set	50 g



1.001.209

Cover shields for MULTIBLOC® and MULTIVERT® for supporting edge 90 mm

CATALOG NUMBER	ITEM NUMBER	DESIGN	PKG	WEIGHT
1.001.205	B1026422	cover shield for MULTIBLOC® size 00, for total length 350mm, 1 set = top cover shield + bottom cover shield	1 set	80 g
1.001.206	C1026423	cover shield for MULTIBLOC® size 1, for total length 350mm, 1 set = top cover shield + bottom cover shield	1 set	0.11 kg
1.001.207	E1026425	cover shield for MULTIBLOC® size 2, for total length 350mm, 1 set = top cover shield + bottom cover shield	1 set	0.12 kg
1.001.208	D1026424	cover shield for MULTIBLOC® size 3, for total length 350mm, 1 set = top cover shield + bottom cover shield	1 set	0.12 kg
1.001.209	F1026426	cover shield for MULTIVERT® 160 A triple pole switching, for total length 350 mm, 1 set = top cover shield + bottom cover shield	1 set	50 g



GLOBAL EXPERT
IN ELECTRICAL POWER
AND ADVANCED MATERIALS

EUROPE

FRANCE
MERSEN France SB S.A.S.
15 rue Jacques de Vaucanson
F-69720 Saint-Bonnet-de-Mure
+33 4 72 22 66 11
info.sbm@mersen.com

ASIA

CHINA
MERSEN Shanghai Co. Ltd.
No.55-A6. Shu Shan Road, Songjiang
201611 Shanghai
+8621 67602388

AMERICAS

USA
MERSEN USA
Newburyport-MA L.L.C.
374 Merrimac Street
Newburyport, MA 01950
+1 978-462-6662



EP.MERSEN.COM